



Products you need  
from people who care

## FULL LINE CATALOG

We offer the widest range of high-efficiency  
hydronic heating and DHW products,  
designed around your needs.



**GAS BOILERS | WATER HEATERS | COMBI FURNACES**

For more information contact your local NTI representative or visit [ntiboilers.com](http://ntiboilers.com)

# TABLE OF CONTENTS

---

## CONDENSING GAS BOILERS

- 07** TFTN Series
- 10** FTVN Combi
- 12** FTVN Heat Only
- 14** TRX Combi
- 16** TRX Heat Only
- 18** New Product - 2024
- 20** Lx Series
- 22** FTG Series
- 24** Boiler Selection Guide

## WATER HEATING

- 27** Lx-WH Series
- 29** Trin & Stor Tanks

## INTEGRATED SYSTEMS

- 33** S20W High-Output Combi System
- 35** GF150 Combi Furnace

## OIL AND WOOD

- 38** Caprice, WF Series

## ACCESSORIES

- 40** Boiler and Tank Parts

## WARRANTIES

- 42** High-Efficiency Gas Product Limited Warranty
- 44** Indirect Water Heater and Storage Tank Limited Lifetime Warranty

# ABOUT NTI BOILERS

---

**We're NTI.**  
**The partner you can trust.**

**We offer unmatched product quality and service. Our engineers strive to set new standards for high efficiency gas boilers, water heaters and combi furnaces.**

NTI is an industry leader and we have been committed to providing smart climate solutions and personal customer support since we were founded in 1967. Today our head office and manufacturing facility are located on the stunning Drury Cove in Saint John, NB, a location chosen to delight those who visit us.

We are not only pioneers in the development of the most advanced and efficient central heating systems, but at NTI we listen to our customers and use their feedback to guide our innovation. Our knowledgeable, accessible friendly staff are here to support every customer to maximize product performance... and just make their jobs easier.

Acknowledged as a leader in research and product development, NTI manufactures its top-quality, hydronic products in accordance with the most advanced guidelines and industry codes. Its products are developed using state-of-the-art design and testing techniques.

The on-site laboratory and training facilities ensure to maintain NTI commitment to enduring quality, product development and contractor support.

**Our customer service team, extended warranty programs and unique training opportunities underline our commitment to you. With NTI, you get quality, North American-made products and unparalleled support.**

**When you buy an NTI product, peace of mind is included.**

The NTI brand is the center of excellence for manufacturing and development for heating products, of the Ariston Thermo Group in North America.

All over the world, Ariston Thermo is synonymous with comfort, energy efficiency and respect for the environment, thanks to its high efficiency products, its plants in compliance with the most advanced production standards and excellent pre- and after-sales customer support services. Our global vision with 9 operating companies, in 40 countries, and 26 production facilities on 15 countries.

The Group has now a leadership position in the global thermal comfort market for domestic, commercial and industrial spaces. The Group counts 7,500 employees and, in 2019, it reached 1.7 billion Euros in sales, produced 8.2 million products and allocated 77 million Euros to investments and R&D.

---

**We love to hear your feedback! Contact us at**

**[feedback@ntiboilers.com](mailto:feedback@ntiboilers.com)**

**to provide your opinion on our products and services**

# CONDENSING GAS BOILERS

---

**THE RIGHT SOLUTION  
FOR ANY APPLICATION**

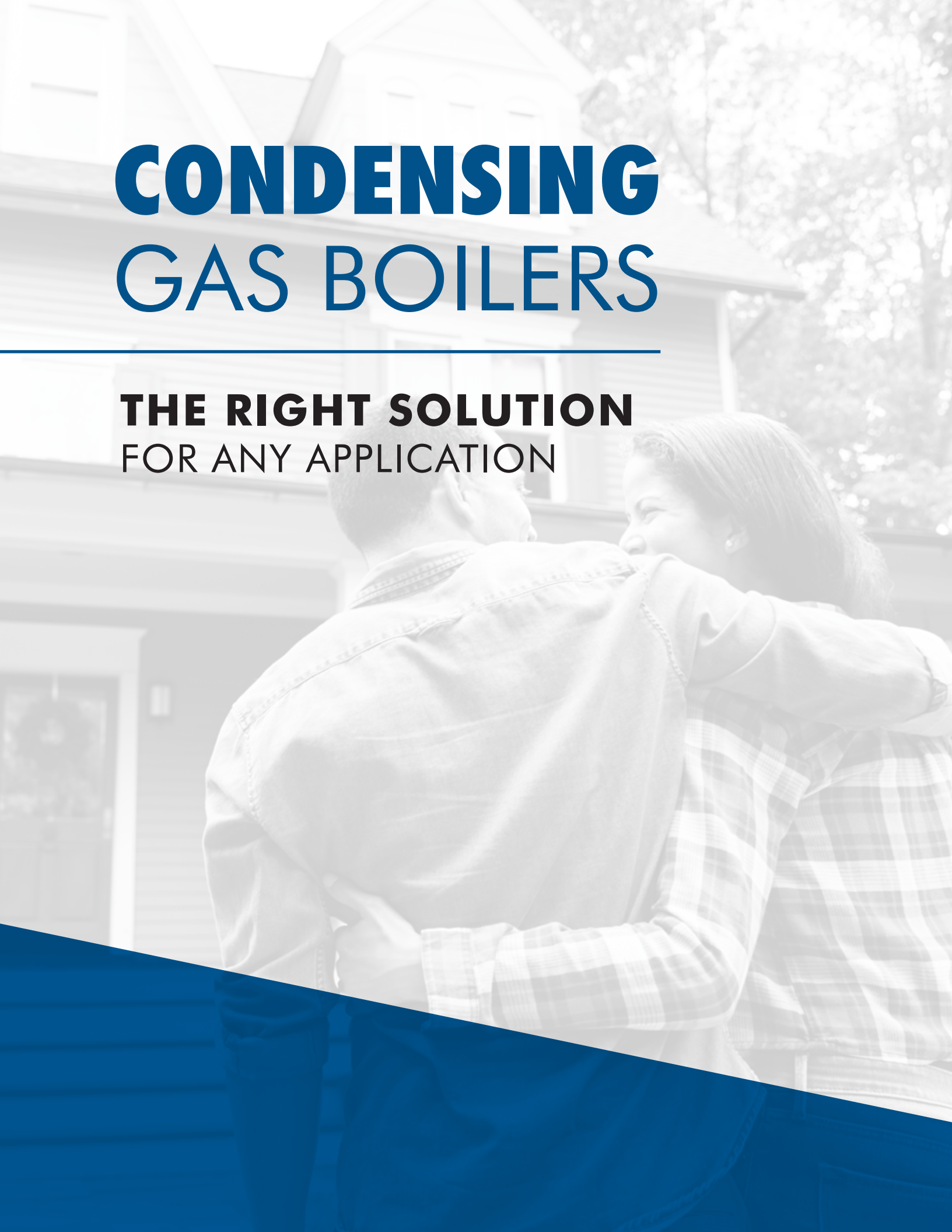

# CONDENSING GAS BOILERS

## FOR ANY NEED

The NTI gas boilers lineup is the widest in the market, allowing our customers to find the right solution for any installation.

Our offering has been designed with our customers at the core of what we do. We are constantly using feedback from the field to guide our innovation. Over the years we have implemented continuous improvements and new features with one goal: your satisfaction.

Here are few of the features that make our boilers unique and allow us to make a difference when it comes to the installation and maintenance of our products:

### Top condensing technology

As one of the pioneers to introduce high efficiency condensing boilers to North America, NTI designs only best in class products.

We use only high quality stainless steel heat exchangers to provide efficiency and reliability at the same time.

**TOP  
EFFICIENCY  
PERFORMANCES**

### Legendary ignition

We are known for our quality startup. All NTI boilers are equipped with an external high-energy spark transformer to ensure proper ignition, each and every time.



### 120V convenience outlet

Cost effective convenience. Selected NTI products come with a built-in 120V convenience outlet. You can use it to power a condensate pump or just to charge your phone!



### Multi-unit cascade function

Connect up to 16 boilers with our integrated cascading function to easily meet even the most demanding installations. No optional devices required.

**INTEGRATED  
CASCADE  
FUNCTION**

### Universal vent connections with embedded test port

Our vent connections include a combustion analyzer test port and can accommodate PVC/CPVC, PP and stainless steel pipes without the need for any adapters.



### Outdoor reset sensor included

We make sure you have the right components you need to install our boilers. Our outdoor reset sensor is high quality and field-tested (and is included!).



Note: Not all features available on all products, please consult the model specifications.



## TFTN

| From 85 to 850 MBH



Supreme Fire Tube:  
Residential and light commercial boiler,  
Touch screen and Wi-Fi enabled.



## FTVN

| From 85 to 199 MBH



Combi available 110, 150, 199 MBH

Fire Tube, made simple:  
High-efficiency, wall-hung fire tube boiler,  
Wi-Fi enabled and peace of mind included.



## TRX

| From 85 to 199 MBH



Combi available 110, 150, 199 MBH

Superior water tube design  
with Wi-Fi: Improved water tube boiler  
design and Wi-Fi enabled.

# COMING SOON!

| New Product - 2024



## LX

| From 200 to 800 MBH

Floor-Standing Water Tube:  
For light to heavy commercial applications, the Lx is the  
ideal option for high-power heating.



## FTG

| From 800 to 2,400 MBH

Floor-Standing Fire Tube:  
For heavy commercial applications delivering maximum  
efficiency and reliable heat.

# TFTN SERIES



## Delivering state-of-the-art functionality and flexibility

TFTN residential and light commercial boilers deliver unprecedented functionality with a proprietary control that is intuitive and easy to program with NTI Net connectivity, and onboard Wi-Fi. Using the same legendary reliability, quality construction and state-of-the-art technology that were at the heart of the TFTN's predecessor, the TFT, trust the TFTN to deliver.

The TFTN features an impressive, **high-quality 7" color Touch screen** and robust new control designed for improved precision and efficiency with easy-to-read graphics. It features NTI's newly designed **EZ SetUp Wizard**, designed with input from contractors, to deliver intuitive, and quick set up and performance.

Available in twelve sizes  
ranging from: **85 MBH**  
to **850 MBH**

**Up to 96% AFUE**

### Main Features:

- EZ Setup Wizard control
- Large color Touch screen
- Can be enabled for 24/7 remote access and monitoring
- Built-in low water cutoff
- Built-in zone control, valves or pumps (can expand to six heating zones)
- Top and bottom plumbing connections for easy installation



Field gas  
convertible  
**NG or LP**

  
**Onboard  
Wi-Fi**

**Cascade  
installation  
up to 8**

  
**High-energy  
spark ignition**

**120V  
Convenience  
Outlet**



## Dimensions - Wall Mount

FRONT

DIM	85-110	150-199	285	340-399
a	34 1/4"	34 1/4"	34 1/4"	36 1/2"
b	3 1/4"	3 1/4"	3 1/4"	5 3/8"
c	19 7/8"	19 7/8"	21 3/8"	25 1/4"
d	42 3/4"	42 3/4"	53 5/8"	57 5/8"

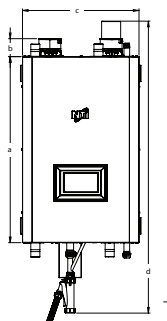

TOP

DIM	85-110	150-199	285	340-399
e	17 1/4"	18 3/4"	18 7/8"	21 1/4"
f	3 7/8"	3 3/4"	5"	4 1/2"
g	N/A	N/A	7 1/2"	N/A
h	6"	6 3/8"	5 1/8"	3 3/8"
i	3 1/2"	3 3/4"	3 3/4"	6 1/2"
j	N/A	N/A	13 3/8"	14"
k	N/A	N/A	7 1/2"	4 3/8"

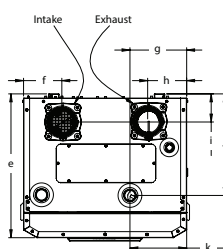

BOTTOM

DIM	85-110	150-199	285	340-399
l	2 3/4"	2 3/4"	2 3/8"	5 5/8"
m	4 5/8"	4 5/8"	7"	8 7/8"
n	5"	6 1/5"	13 1/4"	15 1/2"
o	11 3/4"	12 3/4"	13 7/8"	14 3/4"
p	6 3/8"	7 1/4"	7"	10 7/8"
q	2 1/2"	2 3/8"	2 1/4"	2 5/8"
r	N/A	N/A	5 3/8"	4 1/8"
s	9 7/8"	9 7/8"	8 3/4"	13 7/8"

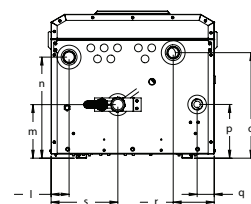

## Specifications - Wall Mount

	TFTN085	TFTN110	TFTN150	TFTN199	TFTN285	TFTN340	TFTN399
CSA Input Modulation (MBH) <sup>1</sup>	8.5 - 85	11 - 110	15 - 150	19.9 - 199	28.5 - 285	39.9 - 340	39.9 - 399
Heating Capacity (MBH) <sup>1,2</sup>	79	101	138	184	263	324	380
Net AHRI Rating, Water (MBH) <sup>1,2</sup>	69	88	120	160	229	282	330
AFUE (%) <sup>2</sup>	96	95	95	95	95	95.4	95.4
Water Connections, NPT (in.)	1-1/4 (M)	1-1/4 (M)	1-1/4 (M)	1-1/4 (M)	1-1/4 (M)	1-1/2 (M)	1-1/2 (M)
Gas Connection, NPT (in.)	3/4 (M)	3/4 (M)	3/4 (M)	3/4 (M)	3/4 (M)	3/4 (M)	3/4 (M)
Vent/Air-inlet Pipe Diameter (in.) <sup>3</sup>	2 or 3	2 or 3	2 or 3	2 or 3	3	4	4
Cabinet Height (in.)	34-1/8	34-1/8	34-1/8	34-1/8	34-1/8	36-1/2	36-1/2
Cabinet Width (in.)	19-7/8	19-7/8	19-7/8	19-7/8	21-3/8	25-1/4	25-1/4
Cabinet Depth (in.)	17-1/4	17-1/4	18-3/4	18-3/4	18-3/8	18-7/8	21-1/4
Approx. Boiler Weight with Water (lbs)	107	107	122	140	180	250	250
Approx. Boiler Water Content (Gallons)	1.4	1.4	2	2.8	4.9	7.1	6.4
Electrical Rating	120V / 1Ph / 60Hz / less than 12A						

- Listed Input and Output ratings are at minimum vent lengths at an altitude of 0-2000 ft. Numbers will be lower with longer venting and/or altitudes greater than 2000 ft.
- Ratings based on standard test procedures prescribed by the U.S. Department of Energy; certified by AHRI. Efficiency listed for models TFTN340 and TFTN399 represents Thermal Efficiency (AFUE is not applicable).
- TFTN units require a special venting system, use only vent materials and methods detailed in the installation manual.

## Specifications - Floor Mount

	TFTN500	TFTN600	TFTN725	TFTN850
CSA Input Modulation (MBH) <sup>4</sup>	50 - 500	60 - 600	72.5 - 725	85 - 850
DOE Heating Capacity (MBH) <sup>4,2</sup>	489	585	705	825
Net AHRI Rating, Water (MBH) <sup>4,2</sup>	425	509	613	717
Combustion Efficiency (%) <sup>2</sup>	98	97.8	97.7	97.6
Thermal Efficiency (%) <sup>2</sup>	97.7	97.5	97.2	97
Water Connections, NPT (in.)	2 (M)	2 (M)	2.5 (M)	2.5 (M)
Gas Connection, NPT (in.)	1 (M)	1 (M)	1-1/4 (M)	1-1/4 (M)
Exhaust Connection (in.) <sup>3</sup>	4	4	6	6
Air Intake Connection (in.)	4	4	4	4
Cabinet Height (in.)	62-1/2			
Cabinet Width (in.)	28-1/4			
Cabinet Depth (in.)	27-5/8			
Approx. Boiler weight with Water (lbs.)	575	575	685	690
Approx. Boiler Water Content (Gallons)	12.5	12.5	17.5	16.5
Electrical Rating	120V / 1Ph / 60Hz / less than 12A			

- Ratings based on standard test procedures prescribed by the U.S. Department of Energy; certified by AHRI. Efficiency listed for models TFTN340 and TFTN399 represents Thermal Efficiency (AFUE is not applicable).
- TFTN units require a special venting system, use only vent materials and methods detailed in the installation manual.
- Ratings based on standard test procedures prescribed by the U.S. Department of Energy; certified by AHRI.

### Accessories:

- TFTN Series tool box
- Low profile vent terminal
- Concentric vent terminal
- Common venting for TFTN 340/399
- System water temperature sensor
- Room sensor thermostat
- N-Link zone control
- BMS Gateway Kit



Residential applications up to 399. See page 41 for warranty.

# FTVN COMBI

## Fire Tube Boilers Made Simple

The FTVN is a high-efficiency, wall-hung boiler equipped with a **vertical fire tube heat exchanger** made of industry proven 439 stainless steel. NTI's user-friendly programmable display features NTI Net connectivity and onboard Wi-Fi. With easy-to-access components, **simple installation, set up and maintenance**, and its unique design the FTVN enables simpler plumbing layouts that **keep costs well under control**.



Available in three sizes:  
**110, 150 & 199 MBH**

**Up to 95% AFUE**  
**10:1 Modulation**

### Main Features:

- Integrated ECM pump and DHW diverter valve
- Fire tube stainless steel heat exchanger
- Integrated easy to service DHW filter
- Universal vent connections with embedded test port
- Wi-Fi on board for remote control and monitoring
- Quick connect components
- Vents in PVC, CPVC or Polypropylene. Check with local jurisdiction.



Field gas  
convertible  
**NG or LP**

  
Onboard  
Wi-Fi

Cascade  
installation  
up to **8**

  
High-energy  
spark ignition



The FTVN Combi has ample space heating capacity and adds abundant hot water via a high-performance brazed plate heat exchanger.

Wi-Fi gateway to allow the boiler to be connected to the internet and remotely accessible.



## Dimensions

A	Central Heating Outlet
B	DHW Outlet (combi or indirect)
C	Gas Inlet
D	DHW Inlet (combi only)
E	Central Heating Inlet
F	Condensate Drain

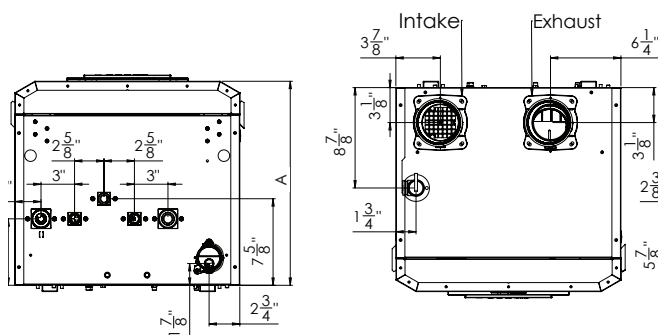

Dimensions (A) - FTVN085 & 110 = 16.5" FTVN150 & 199 = 18"

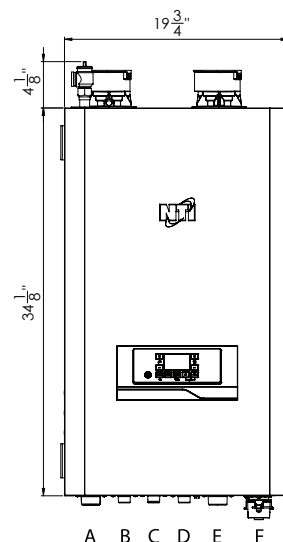

## Specifications

	FTVN110C	FTVN150C	FTVN199C
Input Heating MBH	11 - 110	15 - 150	19.9 - 199
Input (DHW Combi)			
AFUE	95%	95%	95%
Heating Capacity (MBH)	101	138	184
Net AHRI Rating (MBH)	88	120	160
Combi Water Flow at 77° FT Rise	2.7 GPM	3.6 GPM	4.8 GPM
Weight (lbs)	95	106	117
Water Content (Gallons)	1.5		2.8
Water Connections (Heating)	1-1/4" NPT-M		
Water Connections (DHW)	3/4" NPT-M		
2" Inlet & Exhaust Distance	100' max		
3" Inlet & Exhaust Distance	150' max		
Gas Connection All Models	3/4" Male		

### Accessories:

- FTVN Series tool box
- Floor stand
- Low profile vent terminal
- Concentric vent terminal
- Tempering valve
- System water temperature sensor
- Room sensor thermostat
- N-Link zone control
- Room sensors
- Primary/secondary manifold



See page 41 for warranty.



# FTVN HEAT ONLY



OPTIONAL FLOOR  
MOUNT KIT #86998

## Fire Tube Boilers Made Simple

The FTVN is a high-efficiency, wall-hung boiler equipped with a **vertical fire tube heat exchanger** made of industry proven 439 stainless steel. NTI's user-friendly programmable display features NTI Net connectivity and onboard Wi-Fi. With easy-to-access components, **simple installation, set up and maintenance**, and its unique design the FTVN enables simpler plumbing layouts that **keep costs well under control**.

The FTVN features a powerful high efficiency ECM pump, to quietly circulate water through the boiler and boiler primary loop, or boiler and indirect water heater loop – AN EXTERNAL DHW PUMP IS NOT REQUIRED.

The FTVN has been designed with service in mind. The components are each easily removable, and the space within the cabinet has been maximized so that your hard working hands have space to work. The swing down control box also enhances serviceability, making all major components easily accessible.

Available in four sizes:  
**85, 110, 150 & 199 MBH**

**Up to 96% AFUE**  
**10:1 Modulation**

### Main Features:

- Fire tube stainless steel heat exchanger
- Quick connect components
- Universal vent connections with embedded test port
- Vents in PVC, CPVC or Polypropylene. Check with local jurisdiction.



Field gas  
convertible  
**NG or LP**

Onboard  
Wi-Fi

Cascade  
installation  
up to **8**

High-energy  
spark ignition

Every unit is equipped with an embedded Wi-Fi gateway to allow the boiler to be connected to the internet and remotely accessible via "NTI Remote Contractor", NTI's web based telediagnostic service. The web based service provides registered "NTI Remote Contractors" with an easy way to manage their NTI boiler installations, while providing remote access to the brain of each connected boiler.

Service companies can monitor all their installed Wi-Fi NTI boilers with the NTI Web App. Thanks to the remote diagnostic system and 24/7 remote monitoring, it is now possible to be closer to your customer than ever before.

## Dimensions

A	Central Heating Outlet
B	DHW Outlet (combi or indirect)
C	Gas Inlet
D	DHW Inlet (combi only)
E	Central Heating Inlet
F	Condensate Drain

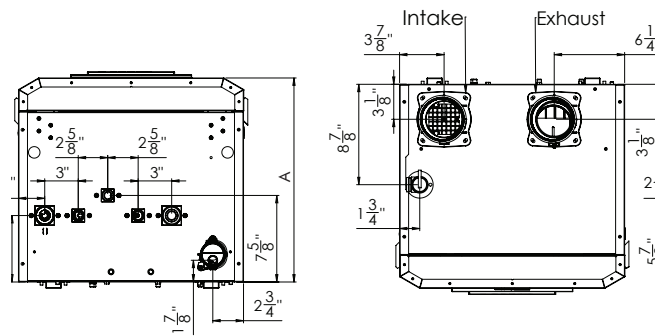

Dimensions (A) - FTVN085 & 110 = 16.5" FTVN150 & 199 = 18"

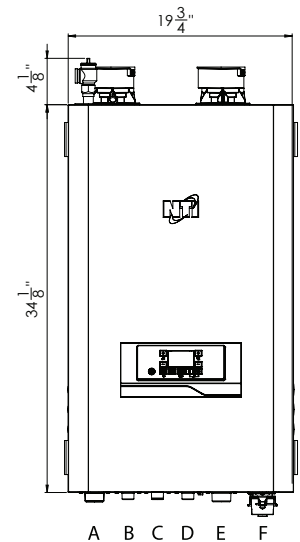

## Specifications

	FTVN085	FTVN110	FTVN150	FTVN199
Input Heating MBH	8.5 - 85	11 - 110	15 - 150	19.9 - 199
Input (DHW Combi)				
AFUE	96%	95%	95%	95%
Heating Capacity (MBH)	79	101	138	184
Net AHRI Rating (MBH)	69	88	120	160
Combi Water Flow at 77° FT Rise	N/A			
Weight (lbs)	95	95	105	116
Water Content (Gallons)	1.4	1.4	2.0	2.8
Water Connections (Heating)	1-1/4" NPT-M			
Water Connections (DHW)	3/4" NPT-M			
2" Inlet & Exhaust Distance	100' max			
3" Inlet & Exhaust Distance	150' max			
Gas Connection All Models	3/4" Male			

### Accessories:

- FTVN Series tool box
- Floor stand
- Low profile vent terminal
- Concentric vent terminal
- System water temperature sensor
- Room sensor thermostat
- N-Link zone control
- Room sensors
- Primary/secondary manifold



See page 41 for warranty.



# TRX COMBI



## High efficiency heating in DHW and conductivity

The TRX is the **advanced NTI platform, the new industry standard**, for Combi applications. The improved water flow design, NTI Net connectivity and onboard Wi-Fi makes the TRX the best choice available on the market.

This boiler provides superior performance for both space heating and domestic hot water, providing you all the heat you need in one compact and affordable package.



Available in three sizes:  
**110, 150 & 199 MBH**

**Up to 95.5% AFUE**

### Main Features:

- Innovative XTRATECH® Heat exchanger
- Integrated primary pump
- Modulating combustion up to 11:1
- Integrated ECM pump and DHW diverter valve
- Easy service access and quick component connections
- DHW flow switch and serviceable filter
- Vents in PVC, CPVC or Polypropylene. Check with local jurisdictions.

The TRX Combi has ample space heating capacity and adds abundant hot water via a high-performance brazed plate heat exchanger.

Wi-Fi gateway to allow the boiler to be connected to the internet and remotely accessible.



Field gas  
convertible  
**NG or LP**

  
**Onboard  
Wi-Fi**

**Cascade  
installation  
up to 8**

  
**High-energy  
spark ignition**

## Dimensions

A	Central Heating Outlet
B	Domestic Hot Water Outlet
C	3/4" Gas Inlet
D	Domestic Hot Water Inlet
E	Central Heating Inlet
F	Condensate Drain
G	Electrical Connections

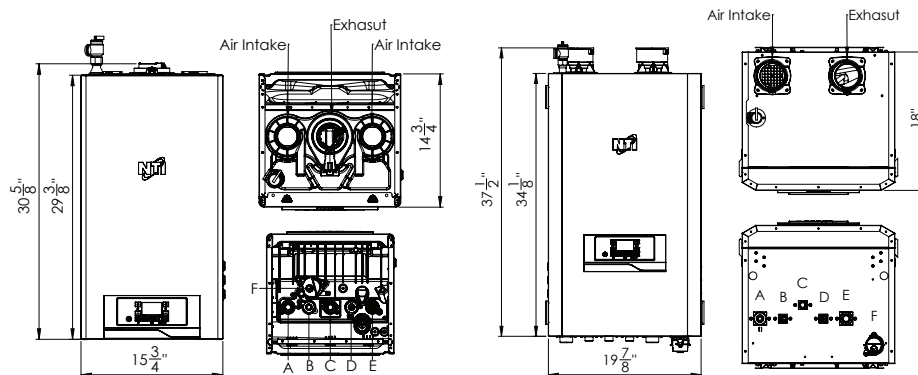

TRX085, 110, 110C, 120 & 150C

TRX150, 199, 199C

## Specifications

	TRX110C	TRX150C	TRX199C
Input Heating	11.2-106 MBH	13.2 - 120 MBH	19.7 - 197 MBH
Input DHW	11.2-114 MBH	13.2 - 150 MBH	
AFUE	95.5%	95%	95%
Heating capacity	98 MBH	111 MBH	184 MBH
Net AHRI Rating	85 MBH	97 MBH	160 MBH
DHW Flow Rate at 77°F T Rise (Combi)	2.7 GPM	3.5 GPM	4.8 GPM
Weight	83.1 lbs	83.6 lbs	135 lbs
Water Content	1.2 gallons		2.7 gallons
Gas Connection	3/4 in. NPT Male		
Water Connections (Heating)	1 in. sweat		1 1/4 in. NPT Male
Water Connection (DHW)	3/4 in. sweat		3/4 in. NPT Male
Air Inlet Connection	2 in. (max 100 ft)		
	3 in. (max 150 ft)		
Flue Connection	2 in. (max 100 ft)		
	3 in. (max 150 ft)		

### Accessories:

- TRX Series toolbox
- Floor stand
- Low profile vent terminal
- Concentric vent terminal
- Tempering valve
- System water temperature sensor
- Room sensor thermostat
- N-Link zone control
- Room sensors
- Primary/secondary manifold



See page 41 for warranty.

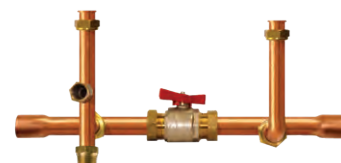

# TRX HEAT ONLY



## The next level of water tube boilers

The TRX is the **advanced NTI platform, and the new industry standard**, for heating boilers. The improved water flow design, NTI Net connectivity and onboard Wi-Fi makes the TRX the best choice available on the market.

This boiler provides both space heating and domestic hot water using an indirect water heater. The TRX provides an internal pump, and diverter valve, eliminating the need for an additional indirect pump and fitting.

All internal components utilize bayonet quick connectors, eliminating the need to braze or solder within the unit. Components can be efficiently serviced. Swing down control box greatly enhances serviceability, making all major components easily accessible.

Available in four sizes:  
**85, 120, 150 & 199 MBH**

**Up to 96% AFUE**

### Main Features:

- Innovative XTRATECH® Heat exchanger
- Modulating combustion up to 10:1
- Integrated ECM pump and DHW diverter valve
- Easy service access and quick component connections
- Vents in PVC, CPVC or Polypropylene. Check with local jurisdictions

Every unit is equipped with an embedded Wi-Fi gateway to allow the boiler to be connected to the internet and remotely accessible via “NTI Remote Contractor”, NTI’s web based tele-diagnostic service. The web based service provides registered “NTI Remote Contractors” with an easy way to manage their NTI boiler installations, while providing remote access to the brain of each connected boiler.

Service companies can monitor all their installed Wi-Fi NTI boilers with the NTI Web App. Thanks to the remote diagnostic system and 24/7 remote monitoring, it is now possible to be closer to your customer than ever before.



Field gas convertible  
**NG or LP**

Onboard  
Wi-Fi

Cascade  
installation  
up to **8**

High-energy  
spark ignition

## Dimensions

A	Central Heating Outlet
B	Domestic Hot Water Outlet
C	3/4" Gas Inlet
D	Domestic Hot Water Inlet
E	Central Heating Inlet
F	Condensate Drain
G	Electrical Connections

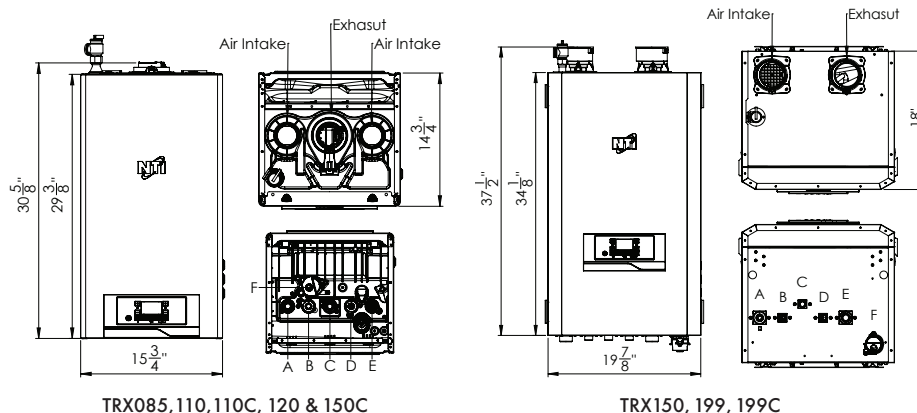

## Specifications

	TRX085	TRX120	TRX150	TRX199
Input Heating	9.4 - 85 MBH	13.2-120 MBH	15-150 MBH	19.7-197 MBH
Input DHW				
AFUE	96%	95%	95%	95%
Heating capacity	79 MBH	111 MBH	139 MBH	184 MBH
Net AHRI Rating	69 MBH	97 MBH	121 MBH	160 MBH
DHW Flow Rate at 77°F T Rise (Combi)	N/A	N/A	N/A	N/A
Weight	78.5 lbs	84.4 lbs	115 lbs	130 lbs
Water Content	1.1 gallons		2.0 gallons	2.7 gallons
Gas Connection	¾ in. NPT Male			
Water Connections (Heating)	1 in. sweat		1 ¼ in. NPT Male	
Water Connection (DHW)	¾ in. sweat		¾ in. NPT Male	
Air Inlet Connection	2 in. (max 100 ft)			
	3 in. (max 150 ft)			
Flue Connection	2 in. (max 100 ft)			
	3 in. (max 150 ft)			

### Accessories:

- TRX Series toolbox
- Floor stand
- Low profile vent terminal
- Concentric vent terminal
- Tempering valve
- System water temperature sensor
- Room sensor thermostat
- N-Link zone control
- Room sensors
- Primary/secondary manifold



See page 41 for warranty.



# NEW PRODUCT

---



**Coming  
2024!**

NTI has been a leader in boiler design since 1967.

**Innovation is in our DNA.**

Watch for more information coming soon.

---

# LX SERIES

## When you need more power we've got you covered

For light to heavy commercial applications, the Lx is the ideal option, with its easy to clean, **high power stainless steel heat exchanger**. The Lx Series boilers are designed for floor standing installation and can be also mounted wall-hung up to 399 MBH.

Its easy-to-access electronic board and well accessible components make it easy service and regular maintenance.

Cascade management and other outstanding programming features can be easily controlled by the intuitive touch screen display.

Available in six sizes  
ranging from: **200 MBH**  
to **800 MBH**

**Up to 94%**  
Thermal Efficiency

### Main Features:

- Touch screen intuitive display
- Easy cleaning stainless steel heat exchanger
- Wall hung kit included for Lx200-400
- High power sizes up to 800 MBH
- Easy access to the display and internal components
- Advanced cascade settings
- Vents in PVC, CPVC or Polypropylene. Check with local jurisdiction.



Field gas  
convertible  
**NG or LP**

Outdoor reset

Cascade  
installation  
up to **8**

High-energy  
spark ignition



# Dimensions

**Lx300–400**

\*Please refer to Lx Series Brouchure for dimension of Lx150–200 and Lx500–800

FRONT

DIM	300	400
a	39 3/4"	39 3/4"
b	17 1/4"	17 1/2"
c	36 1/4"	36 1/4"
d	11 3/4"	11 3/4"
e	9 1/2"	9 1/2"

TOP

DIM	300	400
f	21 1/2"	24"
g	4 1/4"	4 1/4"
h	8 1/2"	8 1/2"
i	4 1/4"	4 1/4"
j	10 3/4"	16 1/2"

SIDE

DIM	300	400
k	24 1/2"	24 3/4"
l	2 3/4"	3 1/4"
m	7"	9 1/2"

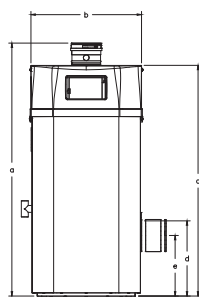

FRONT

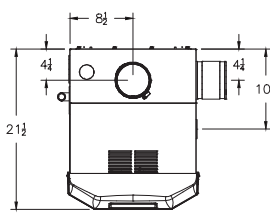

TOP

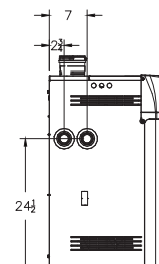

SIDE

# Specifications\*

		Lx200	Lx300	Lx400	Lx500	Lx600	Lx800
Input Power	Natural Gas	25 - 199 MBH	55 - 275 MBH	75 - 399 MBH	100 - 500 MBH	120 - 600 MBH	160 - 800 MBH
	Propane					N/A	N/A
AFUE		93.5%	93.7%	94% Thermal Efficiency			
Heating capacity		181 MBH	251 MBH	375 MBH	470 MBH	564 MBH	752 MBH
Net AHRI Rating		157 MBH	218 MBH	326 MBH	409 MBH	490 MBH	654 MBH
Installation type		Indoor Floor Standing (Wall Hung kit included)			Indoor Floor Standing		
Weight		125 lb	180 lb	225 lb	320 lb	380 lb	475 lb
Gas connection		½ in NPT female	½ in NPT female	¾ in NPT female	¾ in NPT female	1 in NPT male	
Water connections		1 in NPT female	1¼ in NPT female	1 ½ in NPT female	2 in NPT female		
Air Inlet		3 in (max 105 ft)	4 in (max 100 ft)				6 in (max 100 ft)
Flue		3 in (max 105 ft)	4 in (max 100 ft)				6 in (max 100 ft)

\* Lx150 and Lx700 also available. Please refer to Lx Series Brochure for specifications

## Accessories:

- Lx Series tool box
- Concentric vent terminal
- Low profile vent terminal
- System water temperature sensor



See page 41 for warranty.

# FTG SERIES

## All the power you need for any commercial applications

The FTG is a **stainless steel high efficiency fire tube commercial boiler** that ranges from 800 MBH to 2,350 MBH.

The FTG features a dynamic **multiple heat exchanger design**, with single blower, gas valve and burner.

The **user-friendly touch screen display** and **advanced programmable features** make it the ideal choice for dependable and highly demanding commercial applications.

The FTG Series has been designed to provide a reliable source of heat at the maximum energy efficiency levels, without compromises.

Available in six sizes  
ranging from: **800 MBH**  
to **2,400 MBH**

Up to **96%**  
Thermal Efficiency

### Main Features:

- Touch screen intuitive display
- High performance fire tube stainless steel heat exchanger
- Integrated low water cut-off
- Integrated combustion air filter
- CSD-1 compliant
- Advanced cascade settings
- Sealed cabinet
- Vents in PVC, CPVC or Polypropylene. Check with local jurisdiction.



Field gas  
convertible  
**NG or LP**

Outdoor reset

Cascade  
installation  
up to **8**

High-energy  
spark ignition

**120V**  
Convenience  
Outlet



## Dimensions

FRONT					
DIM	600-800	1200	1400	2000	2200-2400
k	68 1/4"	67"	67"	67 1/2"	67 1/2"
l	34"	34"	34"	34"	34"
m	61 3/4"	61"	61"	61 1/2"	61 1/2"

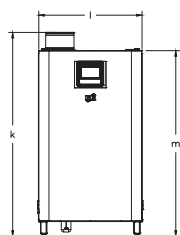

FRONT

SIDE					
DIM	600-800	1200	1400	2000	2200-2400
n	17 1/4"	67"	67"	67 1/2"	67 1/2"
o	44 1/2"	44 1/4"	44 1/4"	44 3/4"	44 3/4"
p	54 1/2"	54 1/4"	54 1/2"	53 1/2"	53 1/2"

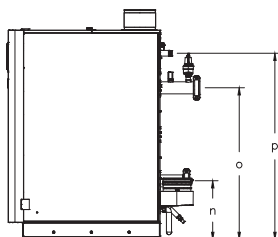

SIDE

TOP					
DIM	600-800	1200	1400	2000	2200-2400
a	8 1/2"	11 1/2"	11 1/2"	11 3/4"	11 3/4"
b	8 1/2"	8 3/4"	8 3/4"	8 1/2"	8 1/2"
c	4"	5 1/2"	5 1/2"	5 3/4"	5 3/4"
d	7"	7"	7"	7"	7"
e	12 1/2"	12 1/4"	12 1/4"	12"	12"
f	13"	13"	13"	13"	13"
g	17"	17"	17"	17"	17"
h	11"	11"	11"	11"	11"
i	5"	5"	5"	5"	5"
j	29 1/4"	44 1/4"	44 1/4"	60 1/4"	60 1/4"

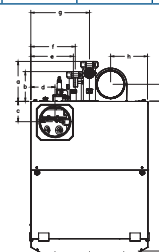

TOP

## Specifications\*

		FTG800	FTG1200	FTG1400	FTG2000	FTG2200	FTG2400
Input Power	Natural Gas	80 - 800 MBH	120 - 1,200 MBH	140 - 1,400 MBH	235 - 2,000 MBH	235 - 2,200 MBH	235 - 2,350 MBH
	Propane						
Thermal Efficiency		95%	96.1%	96%	96%	95.6%	95.2%
Heating capacity		760 MBH	1,153 MBH	1,344 MBH	1,920 MBH	2,103 MBH	2,237 MBH
Net AHRI Rating		660 MBH	1,003 MBH	1,169 MBH	1,670 MBH	1,829 MBH	1,945 MBH
Installation type		Indoor Floor Standing					
Weight		780 lb	1,210 lb		1,710 lb		
Gas connection		1 in NPT female	1 ¼ in NPT female		1 ½ in NPT male		
Water conn.	Inlet	3 in groove joint					
	Outlet	2 in groove joint	3 in groove joint				
Air Inlet		6 in (max 150 ft)	8 in (max 150 ft)				
Flue		6 in (max 150 ft)	8 in (max 150 ft)				

\* FTG600 also available. Please refer to FTG Series Brochure for specifications

### Accessories:

- System water temperature sensor
- BACnet interface



See page 41 for warranty.

# CONDENSING GAS BOILER SELECTION

This boiler selection guide is meant to provide a quick overview of the NTI wide product range. For detailed information about a specific product, please see relevant product brochures and manuals or visit [ntiboilers.com](http://ntiboilers.com)

	HEAT ONLY		
	TFTN	FTVN	TRX
Max Power Input	85 - 399 MBH	85-199 MBH	85-197 MBH
Turn Down ratio	up to 10:1	10:1	up to 10:1
Efficiency	up to 96% AFUE	up to 96% AFUE	95% AFUE
Heat Exchanger	Stainless Steel Fire Tube	Stainless Steel Fire Tube	Stainless Steel Water Tube
Boiler Controller	NTI EZ Setup Wizard	NTI Net Control	NTI Net Control
Combustion air intake	Direct connection	Sealed Cabinet	Sealed Cabinet
Internal piping material	Stainless Steel	Copper	Copper
Water connections	Top and Bottom	Bottom	Bottom
Cascade installation	√ (up to 8)	√ (up to 8)	√ (up to 8)
Propane conversion kit	√	√	√
Outdoor reset	√	√	√
Integrated Low Water Cut-off	√		
Integrated primary Loop pump	√	√	√
Integrated indirect tank circulation pump	√	√	√
Dedicated indirect tank connections	√	√	√
High Voltage Spark Ignition	√	√	√
Integrated 120 V condensate pump receptacle	√		
Warranty	Parts	5y	5y
	Heat Exchanger	Limited Lifetime*	Limited Lifetime*
Ideal for	High end boiler for residential or light commercial applications	Cost effective and reliable space heating residential applications	Cost effective and reliable space heating residential applications

\* Residential application only. Please see page 41 for warranty.

<b>NEW!! Coming 2024</b>	<b>COMBI</b>			
	<b>Lx</b>	<b>FTG</b>	<b>TRX COMBI</b>	<b>FTVN COMBI</b>
	150 - 800 MBH	800 - 2,400 MBH	DHW: 114-197 MBH Heating: 106-197 MBH	110-199 MBH
	up to 8:1	up to 10:1	up to 11:1	10:1
	93.5% AFUE / 94% T.E.	96% T.E.	95% AFUE	95% AFUE
	Stainless Steel Water Tube	Stainless Steel Fire Tube	Stainless Steel Water Tube	Stainless Steel Fire Tube
	NTI ifLEX Touch Screen	NTI ifLEX Touch Screen	NTI Net Control	NTI Net Control
	Direct connection	Sealed Cabinet	Sealed Cabinet	Sealed Cabinet
	N/A	N/A	Copper	Copper
	Left	Rear	Bottom	Bottom
	√ (up to 8)	√ (up to 8)	√ (up to 8)	√ (up to 8)
	√ (except Lx600 - Lx800)	√	√	√
	√	√	√	√
		√		
			√	√
			N/A	N/A
			N/A	N/A
	√	√	√	√
		√		
	2y	2y	5y	5y
	10 years	10 years	Limited Lifetime*	Limited Lifetime*
	Light to heavy commercial applications	Fire Tube boiler for commercial applications of any kind	Cost effective and reliable combination residential boiler	Cost effective and reliable fire tube combination residential boiler

\* Residential application only. Please see page 41 for warranty.



# **WATER HEATING**

---

**ABUNDANT HOT WATER**  
FOR ANY APPLICATION

# LX-WH SERIES

## Gas condensing volume water heater for commercial use

The Lx-WH combines quality with unmatched efficiency while providing a tremendous output capacity. The **high power stainless steel heat exchanger** is easy to clean and install. The **touch screen display is user-friendly**, and the Lx-WH offers **advanced programming features**.

Available in six sizes  
ranging from: **199 MBH**  
to **800 MBH**

**Up to 96%**  
Thermal Efficiency

### Main Features:

- Touch screen intuitive display
- Easy to clean stainless steel heat exchanger
- Floor or wall-mount options
- Ideal coupling with Trin&Stor Storage tanks
- High power sizes up to 800 MBH
- Easy access to the display and internal components
- Advanced cascade settings



Field gas  
convertible  
**NG or LP**

Outdoor reset

Cascade  
installation  
up to **8**

High-energy  
spark ignition



## Dimensions

FRONT		
DIM	300	400
a	39 3/4"	39 3/4"
b	17 1/4"	17 1/2"
c	36 1/4"	36 1/4"
d	11 3/4"	11 3/4"
e	9 1/2"	9 1/2"

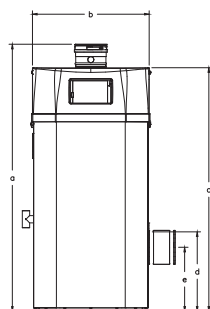

FRONT

TOP		
DIM	300	400
f	21 1/2"	24"
g	4 1/4"	4 1/4"
h	8 1/2"	8 1/2"
i	4 1/4"	4 1/4"
j	10 3/4"	16 1/2"

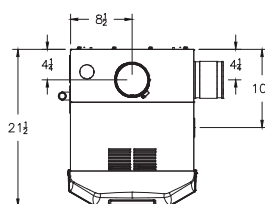

TOP

SIDE		
DIM	300	400
k	24 1/2"	24 3/4"
l	2 3/4"	3 1/4"
m	7"	9 1/2"

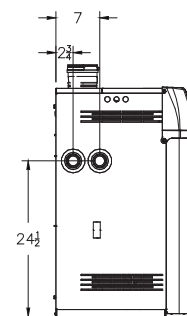

SIDE

## Specifications\*

		Lx200WH	Lx300WH	Lx400WH	Lx500WH	Lx600WH	Lx800WH
Input Power	Natural Gas	25 - 199 MBH	55 - 275 MBH	75 - 399 MBH	100 - 500 MBH	120 - 600 MBH	160 - 800 MBH
	Propane					N/A	N/A
GPH at 100°F T Rise		229 GPH	317 GPH	460 GPH	576 GPH	691 GPH	922 GPH
Thermal Efficiency		96%					
Installation type		Indoor Floor Standing (Wall Hung kit included)			Indoor Floor Standing		
Weight		125 lb	180 lb	225 lb	320 lb	380 lb	475 lb
Gas connection		½ in NPT female	½ in NPT female	¾ in NPT female	¾ in NPT female	1 in NPT male	
Water connections		1 in NPT female	1 in NPT female	1 ¼ in NPT female	2 in NPT female		
Air Inlet		3 in (max 105 ft)	4 in (max 100 ft)				6 in (max 100 ft)
Flue		3 in (max 105 ft) 4 in (max 105 ft)	4 in (max 100 ft)				6 in (max 100 ft)

\* Lx700 WH also available

### Accessories:

- Lx-WH Series tool box
- System water temperature sensor

**5y / 2y**

PRIMARY HEAT EXCHANGER

PARTS

**WARRANTY**

See page 41 for warranty.

# TRIN & STOR TANKS

## Highest quality stainless steel indirect water heaters and storage tanks

The Trin & Stor passivated steel **storage tanks are renowned for maximum resistance to corrosion, which increases their longevity.** Their **high-quality construction and components** make these storage tanks a popular product, and they come in a **wide range of sizes to fit any need.**

Available in two models with sizes ranging from:  
**40 gallons to 120 gallons**

### Main Features:

- Pickled and passivated 444 stainless steel construction
- Simple and quick aquastat connection
- Lead free
- High accuracy tank sensor
- Widest product range from 40 to 120 gallons
- Highest quality construction

**S/S**  
TANK

  
AQUASTAT  
CONNECTION

  
TANK  
SENSOR

  
C US  
Low Lead Content

## S SERIES



## V SERIES



## Dimensions

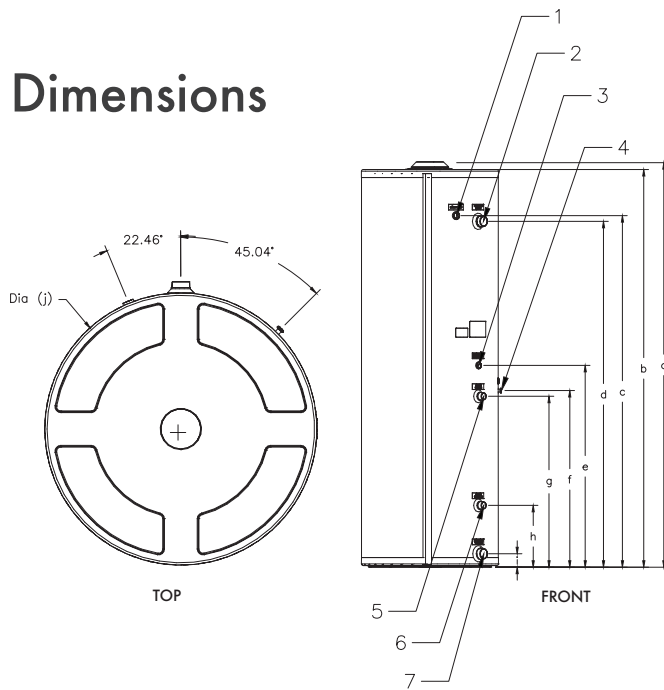

DIM	S40	S50	S65	S80	S120	ST80	ST120
a	56"	49"	70 1/2"	70 1/4"	—	—	—
b	54 3/4"	47 3/4"	69 1/4"	69"	64 3/4"	72 3/4"	65"
c	46 3/4"	39 3/4"	60 1/4"	61"	53 1/2"	59 1/2"	52 1/2"
d	46 3/4"	39 1/2"	60 1/4"	60"	53 1/4"	59 1/2"	52 1/2"
e	29"	29 1/2"	32 1/2"	35"	44 1/2"	10 3/4"	12 3/4"
f	25"	26"	27"	29 1/2"	40 1/2"	—	—
g	26"	27"	28"	30 1/2"	41 1/2"	11 1/2"	13 1/4"
h	9 1/2"	10"	10 1/4"	10 3/4"	12 1/4"	—	—
i	2"	2"	2"	2 1/2"	2 1/2"	2 1/2"	2 1/2"
j	20"	24"	22"	24"	29"	24"	29"
1	3/4" F	3/4" F	3/4" F	3/4" F	3/4" F	1" F	1" F
2	1" M	1"	1"	1 1/2"	1 1/2"	1 1/2"	1 1/2"
3	3/4" F	3/4" F	3/4" F	3/4" F	3/4" F	1 1/2" M	1 1/2" M
4	1" M	1" M	1" M	1" M	1" M	—	—
5	1" M	1" M	1" M	1" M	1" M	—	—
6	1" M	1"	1"	1 1/2"	1 1/2"	1 1/2"	1 1/2"
7	Well	Well	Well	Well	Well	Well	Well

## Dimensions

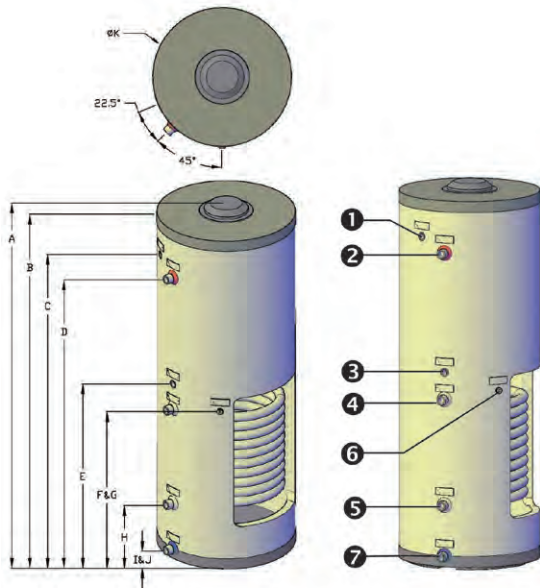

DIM	V40	V50	V65	V80	V120
a	-	-	-	-	-
b	44.9	56.7	54.3	64.2	69.7
c	36.4	48.2	45.1	55	59.8
d	36.4	48.2	45.1	54.6	59.4
e	28.5	32.5	32.9	37.6	35.4
f	25.4	29.3	29.8	34.5	32.2
g	26.4	30.3	30.7	35.5	33.2
h	8.9	8.9	9.3	9.3	10.2
i	3.1	3.1	3	3.3	3.4
j	3.1	3.1	3	3.3	3.4
k	21.8	21.8	24.5	24.5	28.1
1	3/4" F	3/4" F	3/4" F	3/4" F	3/4" F
2	1" M	1" M	1" M	1" M	1" M
3	3/4" F	3/4" F	3/4" F	3/4" F	3/4" F
4	1" M	1" M	1" M	1" M	1" M
5	1" M	1" M	1" M	1" M	1" M
6	Well	Well	Well	Well	Well
	10mm x 160mm	10mm x 160mm	10mm x 160mm	10mm x 160mm	10mm x 160mm
7	1" M	1" M	1" M	1 1/2" M	1 1/2" M

## Specifications - V Series

INDIRECT WATER HEATERS					
	V40	V50	V65	V80	V120
Storage capacity	38 gal	51 gal	64 gal	77 gal	116 gal
Tank Material	Stainless Steel Indirect				
Weight empty	95 lbs	117 lbs	134 lbs	165 lbs	232 lbs
Weight filled <sup>1</sup>	428 lbs	556 lbs	690 lbs	835 lbs	1235 lbs
Continuous recovery <sup>2</sup>	140°F	182 GPH	211 GPH	277 GPH	314 GPH
	115°F	287 GPH	333 GPH	433 GPH	492 GPH
Boiler output	160 MBH	180 MBH	240 MBH	300 MBH	350 MBH
Coil flow rate	10 GPM	10 GPM	15 GPM	15 GPM	20 GPM
Coil pressure drop	1.6'	2.0'	3.8'	5.1'	10.0'
Hour 1 recovery <sup>2</sup>	140°F	216 gal	251 gal	334 gal	384 gal
	115°F	319 gal	373 gal	485 gal	558 gal

1. Ensure the location chosen for installation can support the weight of the tank when filled with water.
2. Ratings based on 50°F inlet water temperature and 200°F boiler water outlet temperature.

### Accessories:

- Aquastat
- Tank sensor



See page 41 for warranty.

# COMBI

---

EMBRACE A NEW  
**DIMENSION OF COMFORT**

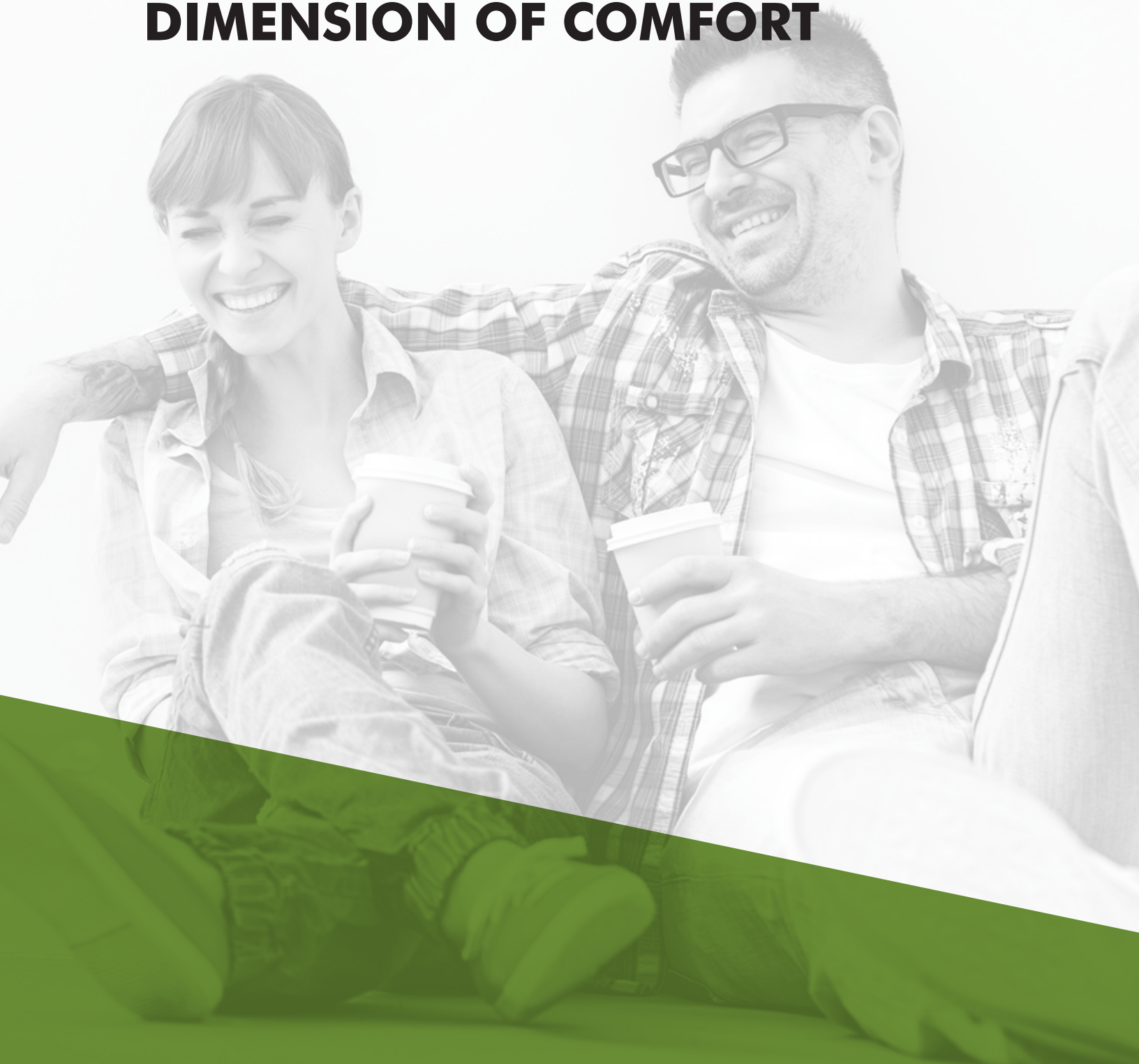

# S20W HIGH-OUTPUT COMBI SYSTEM

## Space saving high-performance wall-mounted indirect water heater

High output is simple when you choose NTI's S20W system:

1. Pair it with one of NTI's six heat-only boiler, and 2. **Tie them together with NTI's made-to-measure Plus Kit.**

The S20W is our highest-performance tank, with recovery rates that exceed most industry standard 50 and 65 gallon. Its stainless steel tank and coil come in a wall-mounted package complete with a metal jacket. **The CFC-free 2" ultra high density EPS insulation ensures low standby losses and each unit comes complete with a thermostatic mixing valve, tank sensor and T&P valve.** A hand hole at the top of the tank allows for inspection and cleaning.

Available in 20 gallons

Pairs with six heat-only NTI boilers

### Main Features:

- Pickled and passivated 444 stainless steel construction
- High quality stainless steel tank and coil, type 444
- CFC-free 2" ultra-high density EPS insulation
- Includes thermostatic mixing valve
- Limited lifetime warranty
- Quick connect with Plus Kit PN87261



## Dimensions

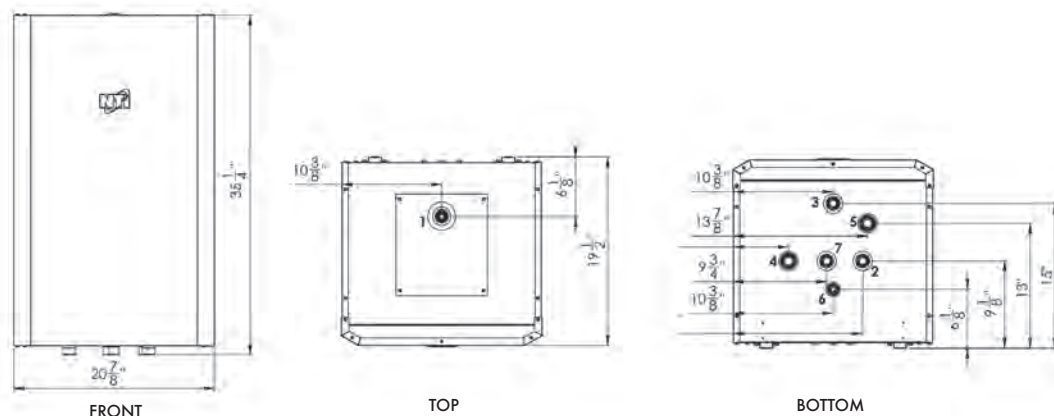

## Specifications

Model	Storage Capacity USG (L)	Type	Weight (lbs)		Hour 1 Recovery (Gal @ Outlet Temp)		Boiler Output MBH	Coil Flow Rate (GPM)	Coil Drop (Feet)	Continuous Rate (Gal @ Outlet Temp)	
			Empty	Filled <sup>1</sup>	140° F	115° F				140° F	115° F
S20W	21 (80)	Stainless Steel Indirect	85	260	290 <sup>2</sup>	445 <sup>2</sup>	232	10	4.5	273 <sup>2</sup>	428 <sup>2</sup>

1. Ensure the location chosen for the S20W tank is capable of supporting the tank when filled with water.
2. Max. hour 1 recovery based on 50°F inlet water temperature and 200°F boiler supply water temperature.

**When matched with the FTVN or TRX the S20W delivers peak performance.**

Model	Max. Hour 1 Recovery (US GPH)		Continuous Rate (US GPH)	
	140°F	115°F	140°F	115°F
FTVN085	119	158	102	141
FTVN110	149	200	132	182
FTVN150	197	266	180	249
FTVN199	229	348	212	330
TRX150	197	266	180	249
TRX199	215	345	198	328

Values are with 50°F inlet water.

# GF150 COMBI FURNACE



## Modern Convenience of Hot Water and Forced Air Combined

The GF150 is a merging of our TRX combi boiler with a high efficiency air handler to provide forced-air heating, domestic hot water and hydronic capabilities. It is an **all-in-one solution** for the future of hot water, heating and comfort for your home.

The GF150 is equipped with Green Furnace control technology features the most advanced components providing whisper quiet heating performance as well as quick and abundant hot water.

**One size fits all**

**Up to 95% AFUE**

### Main Features:

- Innovative technology and outstanding performance
- Combined DHW and space heating appliance
- Most advanced DEC Star ECM blower
- High-efficiency combustion system
- Design innovation
- Integrated plumbing
- Integrated Wi-Fi for remote monitoring and troubleshooting
- Left/right connections



**95%** AFUE



**S/S**  
HEAT EXCHANGER

**ECM**  
MOTOR

**Onboard**  
**Wi-Fi**



New generation ECM motor and blower for whisper quiet performance.

## Dimensions

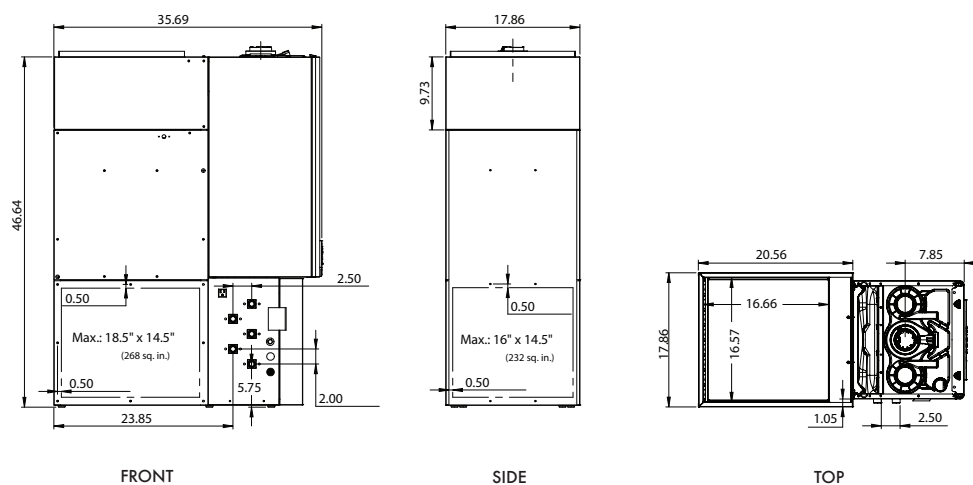

## Specifications

	Forced-Air Heating Capacity		13,200 - 80,000 BTU/H
	Cooling Capacity		Up to 3.0 tons
	Flow Rate (Forced Air)	Heating Ventilation	300 - 1200 CFM (510 - 2040 m <sup>3</sup> /h)
		Cooling	360 - 1200 CFM (612 - 2040 m <sup>3</sup> /h)
	Connection Sizes	DHW Inlet / Outlet	¾ in. NPT-M
		CH Supply / Return	
		Gas Inlet	
	Dimensions (W x H x D)		17 7/8 in. x 48 in. x 35 3/4 in. (454 x 1219 x 908 mm)
	Weight		220 lbs. (100 kg.)
TRX150C*	Power Supply		120V AC, 60 Hz, 15 A
	Energy Efficiency (DOE AFUE)		95%
	Space Heating Capacity (Hydronic + Forced Air)		13,200 - 120,000 BTU/H (4 - 35 kW)
	DHW Capacity		13,200 - 150,000 BTU/H (4 - 44 kW)
	Flow Rate (DHW)	77°F (43°C) Temp Rise	3.6 GPM (14 L/m)
		Minimum	0.5 GPM (2 L/m)
	Water Pressure	DHW Max. Pressure	125 PSI (860 kPa)
		Heat Exchanger MAWP	55 PSI (380 kPa)
	Venting	Length (intake)	2" (0 - 100 ft.)   3" (0 - 150 ft.)
		Length (exhaust)	2" (6 - 100 ft.)   3" (6 - 150 ft.)
		Materials	PVC, CPVC, PP, SS

\*The TRX150C is the boiler component of the GF150.



See page 41 for warranty.

# OIL AND WOOD

---

**WORRY—FREE COMFORT**  
PROVEN BY THE TEST OF TIME

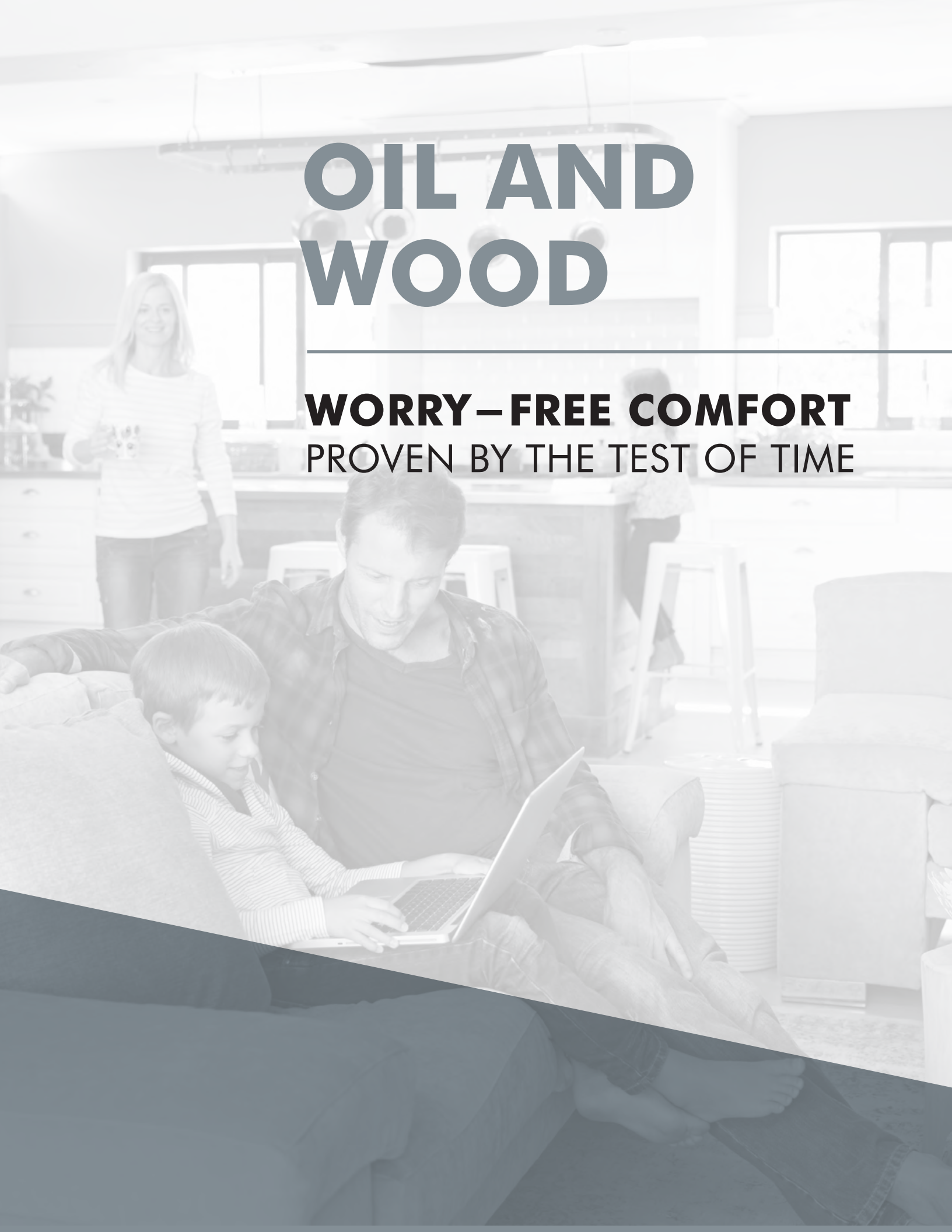

# OIL AND WOOD BOILERS

## Caprice

Our most trusted steel oil boiler for over 50 years

- High efficiency operation, AFUE up to 86.9%
- High-capacity copper coil Outdoor reset and warm weather shutdown
- Domestic hot water priority Direct vent option
- Compact size and easy servicing

MODEL	INPUT GPH	GROSS OUTPUT BTU/H	NET OUTPUT BTU/H	AFUE
C85	.68	83,000	72,000	86.80%
C95	.75	91,000	79,000	86.50%
C105	.85	103,000	90,000	86.00%
C125	1	120,000	104,000	85.20%
CAPRICE COMMERCIAL				
C220	1.75	216,000	188,000	86.90%
C230	1.85	226,000	197,000	86.30%
C250	2	241,000	210,000	85.50%

MODEL	C85-125	C220-340
Stack Size (")	5	8
Water Volume (US Gal)	15	26
Shipping Weight (lbs)	362	440
Overall Length (")	20	23
Overall Width (")	20	23
Overall Height (")	36	42
Inlet-Outlet Size (Npt)	1 1/4	1 1/4
Relief Valve Size (Npt)		3/4
Drain Size (Npt)	1/2	1/2
Direct Venting	C95-125	-
Side Wall Venting (SSV-1)	C95-125	C220-305
Heating Surface (sq ft)	18	26
Standard Coil Size	S4	S4
Max. Coil Size	1-S5	1-S5
CRN Approved*	1279.7	1278.7

\*Must request at time of order.



## WF Series

NTI WF Series is an efficient, compact wood boiler.

- Compact sizes eliminate the need for floor reinforcement
- Greater heating surface
- Lower stack temperature
- No boiler tubes
- Less possibility of cresol buildup
- Thermostat heat control
- Wet leg, high-efficiency boiler design
- Designed to A.S.M.E. requirements

DIM	1 1/4" NPT
	16"W
	25 1/2" D
SUPPLY	1 1/2"
RET	1 1/2"
RV	3/4"
DRAIN	1/2"
SQ. FT. SURFACE	20
WEIGHT	625 lbs.
WATER CAP	43 Imp Gal.
BTU CAPACITY	95,000



# ACCESSORIES

---

**BOILER AND TANK PARTS**  
FOR TOP PERFORMANCE

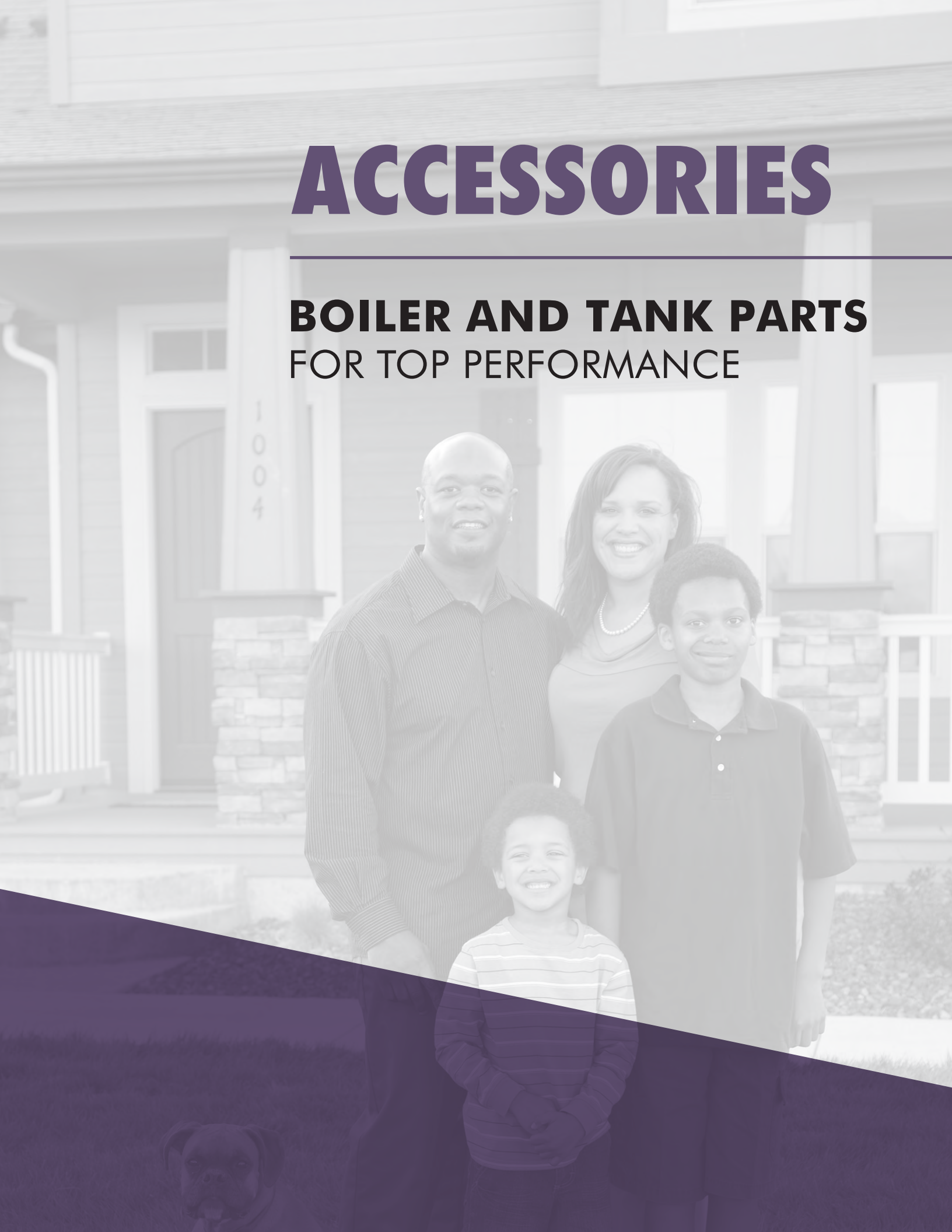

## Accessories

Part Number	Models	Description
87262	All FTVN and TRX 150, 199, 199C	Primary/Secondary Manifold
3319703	TRX 85, 120, 110C, 150C	Primary/Secondary Manifold
87261	TRX 150, 199, FTVN + S20W	High Output Combi System Plus Kit (includes 87262)
86087	GF200	GF200 Tool Box
86417	FTG	FTG Tool box
86641	Lx	Lx400 Tool Box
86640	Lx	Lx150-300 Tool Box
85224	VMax	VMax Tool Box
86320	TFT	TFT 285-399 Tool Box
86319	TFT	TFT 155-250 Tool Box
86318	TFT	TFT 154-201 Tool Box
86317	TFT	TFT 60-110 Tool Box
87112	FTVN	SK90 Service Kit - FTVN Only
87111	TRX/FTVN	SK90 Service Kit - TRX & FTVN
87110	TRX/FTVN	SK70 Service Kit - TRX & FTVN
87099	TRX/FTVN	Cascade Kits - TRX & FTVN
84947	FTG/Lx	ProtoNode LER Modbus-LonWorks
84946	FTG/Lx	ProtoNode RER Modbus-BACnet/N2
3260186	TFTN	BMS Gateway Kit
86369-1	Lx	High Gas Pressure Switch
84649	Lx	Low Gas Pressure Switch
84632	Trin & Stor	Trin & Stor Tank Sensor
84158	Trin & Stor	Trin & Stor TPI Aquastat
82666/84634	TFT/Lx150-200	3" Concentric Vent Terminal
84358	TFT/Lx300-800	4" Low Profile Vent Terminal
84357	TFT/Lx150-200	3" Low Profile Vent Terminal
84355	TFTLx300-800	4" Concentric Vent Terminal
84093	Lx500-800	Indoor Combustion Air kit
84010	All	System/Pipe Sensor
83450	All	Fernox DS40 Descalar
83449	All	Fernox F3 Cleaner
83448	All	Fernox F1 Protector

# WARRANTIES

---



# HIGH-EFFICIENCY GAS PRODUCT LIMITED WARRANTY

Register product purchases at [ntiboilers.com](https://ntiboilers.com). Retain proof of purchase, installation date and all service records.

## A. What Does This Limited Warranty Cover?

This limited warranty covers all parts in your NTI high-efficiency gas product against failure due to defects in materials and workmanship. NTI will replace or, at its sole discretion, repair any defective part. Any replaced part will be warranted for the longer of i) the unexpired portion of the original warranty period or ii) 90 days. Labor and all other costs for the inspection or examination, removal and re-installation of defective parts, and transportation costs for defective or replacement parts, are not covered by this warranty. This warranty applies to all gas units produced on or after Oct. 20, 2021, beginning with serial number 2110202138184177, or those with serial number beginning with 326 or 331.

## B. How Long Does the Coverage Last?

Item	Coverage Duration		
	Residential	Commercial	Volume Water Heater
Heat Exchanger (i.e., pressure vessel)	Limited Lifetime	10 years from installation date	5 years from installation date
All Other Parts	5 years from installation date	2 years from installation date	2 years from installation date

For the applicable duration as per the above chart, repair, or replacement of a heat exchanger that NTI has found to be defective in material or workmanship that resulted in a leak will be provided by NTI, provided this warranty has not otherwise been voided. For residential products only, for the years following the first 10 years, NTI will provide coverage for a percentage of the material cost of a replacement heat exchanger according to the following table:

Year from date of installation	Residential % covered by NTI
11th	75%
12th	
13th	50%
14th	
15th and beyond	25%

Coverage will be applied towards the then current retail price of the replacement heat exchanger. NTI uses its published list pricing to represent current retail pricing. In the case where a replacement heat exchanger is no longer available when the warranty claim is made, NTI will offer a replacement product of similar size and characteristics and any applicable warranty coverage will be applied towards the current retail price of aforementioned product. The amount of coverage toward a replacement product is based upon the percentage of the list price of the heat exchanger on the total list price of the replacement product. For example, if a heat exchanger fails in year 13 of an installation and the list price of the heat exchanger represents 25% of the list price of the replacement

product, the warranty coverage applied to the replacement product would be  $50\% \times 25\% = 12.5\%$  of the retail list price of the replacement product. **If the installation date cannot be determined, the warranty period will be considered to begin 60 days from the date the product was shipped by NTI, which NTI can determine using the product serial number.**

### **C. What Does Residential, Commercial and Volume Water Heater mean?**

Residential Products – are gas condensing boilers that meet all of the following four conditions:

1. Below 401 MBH
2. Installed in a housing unit of 2 dwellings or less
3. Not used in commercial applications and process water heating
4. Average annual run time not exceeding 2,500 hours

Commercial Products – all gas condensing boilers that do not qualify as residential products.

Volume Water Heater – products that operate in an open-loop domestic hot water system.

### **D. How Do You Make a Warranty Claim?**

If you believe you have a claim under this limited warranty, please contact a local heating or plumbing contractor of your choice, that is familiar with the operation and service requirement of high-efficiency, condensing products. Your contractor will perform a diagnosis to determine the cause of the issue and will work with NTI Boilers Inc. to establish as to whether you may have a claim covered by this warranty. If your contractor advises you that you may have a claim covered by this warranty, then the contractor can choose to file the claim directly with NTI Boilers Inc. on your behalf, or work through a local wholesale distribution partner of NTI Boilers Inc. You must make all parts that are subject to a warranty claim available to your contractor for return to NTI. If you have questions about this process or the status of your claim, you may contact the NTI Technical Services at 1-800-688-2575, or email [info@ntiboilers.com](mailto:info@ntiboilers.com). You can also find warranty details and procedures at [www.ntiboilers.com](http://www.ntiboilers.com).

### **E. What Is Not Covered Under This Warranty?**

This warranty is valid only for the original owner at the original location. Additionally, this warranty does not cover claims if the failure, malfunction, or unsatisfactory performance of, or damage to, your Product resulted from or is attributable to:

1. Installation not done in accordance with manufacturer's instructions;
2. Components or replacement parts that are not furnished by NTI;
3. The failure to properly size the product for its use;
4. Repairs or replacement of parts required as a result of poor workmanship of the contractor;
5. Repairs or replacement of parts required due to inaccurate diagnosis and troubleshooting by a contractor that did not include the assistance of the NTI Technical Services Department;
6. Failure to inspect and maintain the venting;
7. Water conditions outside of NTI's acceptable parameters, as stated in the NTI product manuals supplied with the product, including, but not limited to, water chemistry, levels of Total Dissolved Solids (TDS) and pH levels, chemical or electrochemical reaction, water impurities, unsuitable water conditions as per system design guidelines, water treatment chemicals;
8. Sediment, magnetite or scale formation on the water side of the pressure vessel;
9. Operation with contaminated combustion air including, but not limited to, air contaminated externally, air impurities, sulfur or sulfuric action or reaction, dust particles, corrosive vapors, oxygen corrosion;
10. Buildup of dirt, dust or other debris inside the combustion chamber;
11. Installing the product in an unsuitable location or continuing use after onset of a malfunction or discovery of a defect;
12. Information supplied by parties other than NTI without consultation and agreement by NTI;
13. Failure to inspect and service the product in accordance with NTI's product manuals;
14. Freezing, accident, fire, flood, or force majeure, power surges or failures, abuse or misuse, unauthorized alteration;

15. Damages or liability caused by negligent operation, unsuitable or improper use or operation of the product, including, but not limited to, improper installation, incorrect or careless handling, improper start-up, lack of proper adjustment to control parameter default settings, improper control strategy, incorrect combustion adjustment, disregard of the operating and maintenance instructions or any other instructions supplied with the product;
16. Damage to the product or any of its parts caused by matters outside the control of NTI; and
17. Normal wear and tear and/or consumption of parts including, but not limited to, fuses, gaskets, ignitors and electrodes.

If you have any questions about your coverage under this limited lifetime warranty, please contact NTI at [info@ntiboilers.com](mailto:info@ntiboilers.com) or the Contact Us form at [www.ntiboilers.com](http://www.ntiboilers.com). Please review all printed material accompanying the product to learn how to properly care for and maintain your product. Additional information may also be found on our website, listed above.

**NTI'S MAXIMUM LIABILITY SHALL NOT EXCEED THE ACTUAL PURCHASE PRICE PAID BY YOU FOR YOUR PRODUCT. IN NO EVENT SHALL NTI BE RESPONSIBLE FOR INDIRECT, INCIDENTAL, CONSEQUENTIAL (INCLUDING WITHOUT LIMITATION DAMAGE TO OR LOSS OF OTHER PROPERTY), OR PUNITIVE DAMAGES, WHETHER SUCH CLAIM OR ACTION IS BASED ON CONTRACT, WARRANTY, NEGLIGENCE, STRICT LIABILITY, OR ANY OTHER LEGAL THEORY.**

Some states or provinces do not allow the exclusion or limitation of incidental or consequential damages, so the above limitation or exclusion may not apply to you.

**ALL IMPLIED WARRANTIES ARE LIMITED IN THEIR DURATION TO THE APPLICABLE WARRANTY PERIOD STATED ABOVE. ALL IMPLIED WARRANTIES, INCLUDING MERCHANTABILITY AND FITNESS FOR A PARTICULAR PURPOSE, ARE DISCLAIMED IN THEIR ENTIRETY AFTER EXPIRATION OF THEIR APPLICABLE WARRANTY PERIOD SET FORTH ABOVE.** Some states or provinces do not allow limitations on how long an implied warranty lasts, so the above limitation may not apply to you.

## INDIRECT WATER HEATER AND STORAGE TANK LIMITED LIFETIME WARRANTY

---

Register product purchases at [ntiboilers.com](http://ntiboilers.com). Retain proof of purchase, installation date and all service records.

### A. What Does This Limited Warranty Cover?

NTI, the manufacturer, warrant that any parts or components of each new indirect water heater or storage tank, will be supplied free of defects in material or workmanship. This warranty replaces any other warranty implied or expressed.

This Limited Warranty covers the tank and all parts in your NTI indirect water heater and storage tank against failure due to defects in materials and workmanship. NTI will replace or, at the sole discretion of NTI, repair any defective part. Any replaced part will be warranted for the longer of i) the unexpired portion of the original warranty period or ii) 90 days. Labor and all other costs for the inspection or examination, removal and re-installation of defective parts, and transportation costs for defective or replacement parts, are not covered by this warranty.

## B. How Long Does the Warranty Last?

**Parts Warranty:** Two-year limited parts warranty. NTI will repair or replace any component, supplied or manufactured by NTI Boilers Inc., that is found to be defective, for a period of twenty-four (24) months from date of installation, if found to be in compliance with the "Terms and Conditions" of this warranty.

**Tank Warranty:** Limited lifetime warranty. NTI will, at its discretion, repair or replace a tank found to be defective or malfunctioning, resulting in a leakage of water from the tank, for a period of ten (10) years from the date of installation, and if found to be in compliance with the "Terms and Conditions" of this warranty. For the years following the first 10 years, NTI will provide coverage for a percentage of the material cost of a replacement indirect water heater or storage tank according to the following table:

Year from date of installation	Residential % covered by NTI
11th	75%
12th	
13th	50%
14th	
15th and beyond	25%

Warranty coverage period will commence from the date of installation. If the installation date cannot be confirmed through either the product registration or a contractor's Invoice, coverage will be considered to begin 90 days after NTI shipped the product from its warehouse. This shipping date can be determined by NTI using the product serial number.

## C. Terms and Conditions

- This warranty is VOID if:
  - The appliance is not installed and serviced by a licensed and trained heating technician.
  - The installation is not in accordance with this manufacturer's manuals, local codes and regulations.
  - Tank leaks are a result of corrosive effects caused by abnormal water conditions or outside the following water chemistry requirements:
    - Tank water with PH levels outside the limits of 6.0 to 8.0.
    - Tank water with chloride levels (ppm) outside the limits of 0 to 80.
    - Electrical conductivity (EC) exceeding maximum of 125 mS/m @ 25° C
    - Saturation index (LSI) outside the limits of -1.0 to 0.8 @ 80° C
  - Deformation occurs due to freezing, improper storage or handling.
  - Any repairs or replacements made without authorization by or notification to the manufacturer.
- This warranty is valid ONLY to the original owner, at the original installation site. The warranty is NOT transferable.
- The warranty assumes the proper use and care of the appliance and does not cover improper installation, neglect or abuse of the product.
- Tank replacement warranty covers only the tank for leaks caused by corrosive effects of water under "normal conditions" within the water chemistry limits.
- NTI Boilers Inc. is not responsible for reimbursement for labor, fuel or punitive damages caused by the operation or failure of the equipment.
- This warranty does not cover the labor and shipping costs associated with installing a repaired or replaced indirect water heater or storage tank.
- Decision of warranty repairs or replacements to appliances will be at the discretion of the manufacturer or authorized service representative.

## D. How Do You Make A Warranty Claim?

If you believe you have a claim under this limited lifetime warranty, contact a local heating or plumbing contractor of your choice, that is familiar with the operation and service requirement of indirect water heaters and storage tanks. Your contractor will perform a diagnosis to determine the cause of the issue and will work with NTI Boilers Inc. to establish as to whether you may have a claim covered by this Warranty. If your contractor advises you that you may have a claim covered by this warranty, then the

contractor can choose to file the claim directly with NTI Boilers Inc. on your behalf, or work through a local wholesale distribution Partner of NTI Boilers Inc. You must make all parts that are subject to a warranty claim available to your contractor for return to NTI. If you have questions about this process or the status of your claim, you may contact the NTI Technical Services at 1-800-688-2575, or email [info@ntiboilers.com](mailto:info@ntiboilers.com). You can also find warranty details and procedures at [www.ntiboilers.com](http://www.ntiboilers.com).

If you have any questions about your coverage under this limited lifetime warranty, please contact NTI at [info@ntiboilers.com](mailto:info@ntiboilers.com) or the Contact Us form on [www.ntiboilers.com](http://www.ntiboilers.com). Please review all printed material accompanying the product to learn how to properly care for and maintain your Product. Additional information may also be found on our website, listed above.

**NTI'S MAXIMUM LIABILITY SHALL NOT EXCEED THE ACTUAL PURCHASE PRICE PAID BY YOU FOR YOUR PRODUCT. IN NO EVENT SHALL NTI BE RESPONSIBLE FOR INDIRECT, INCIDENTAL, CONSEQUENTIAL (INCLUDING WITHOUT LIMITATION DAMAGE TO OR LOSS OF OTHER PROPERTY, OR PUNITIVE DAMAGES, WHETHER SUCH CLAIM OR ACTION IS BASED ON CONTRACT, WARRANTY, NEGLIGENCE, STRICT LIABILITY, OR ANY OTHER LEGAL THEORY.** Some states or provinces do not allow the exclusion or limitation of incidental or consequential damages, so the above limitation or exclusion may not apply to you.

**ALL IMPLIED WARRANTIES ARE LIMITED IN THEIR DURATION TO THE APPLICABLE WARRANTY PERIOD STATED ABOVE. ALL IMPLIED WARRANTIES, INCLUDING MERCHANTABILITY AND FITNESS FOR A PARTICULAR PURPOSE, ARE DISCLAIMED IN THEIR ENTIRETY AFTER EXPIRATION OF THEIR APPLICABLE WARRANTY PERIOD SET FORTH ABOVE.** Some states or provinces do not allow limitations on how long an implied warranty lasts, so the above limitation may not apply to you.

**NTI Boilers Inc., 30 Stonegate Drive, Saint John, NB, Canada E2H 0A4;**

**Technical Assistance: 1-800-688-2575 or [info@ntiboilers.com](mailto:info@ntiboilers.com)**

Rev: 23/08/02

# Join the pros! Participate in a training session today!

Contact us at:

**1 -800-766-2575 ext. 1**  
**training@ntiboilers.com**

to get in touch with our training team and  
learn about available dates in your area.



## Interested in our products? Contact our Sales Managers:

### Canada

#### VP of Sales Canada

Andrew Smith  
asmith@ntiboilers.com

#### Atlantic Canada

Stacy Baskin  
sbaskin@ntiboilers.com

#### Eastern Canada

Gloria Coelho  
gcoelho@ntiboilers.com

#### Western Canada (BC)

Rob Johnston  
rjohnston@ntiboilers.com

#### Western Canada (Alberta)

Travis Loewen  
tloewen@ntiboilers.com

### USA

#### VP of Sales USA

David Walsh  
dwalsh@ntiboilers.com

#### North East

Ted Lowe  
tlowe@ntiboilers.com

#### Mid Atlantic

Steve Wieland  
skwieland@ntiboilers.com

#### New England South East

Kyle Silvio  
ksilvio@ntiboilers.com

#### Lakes East

David Miller  
dmiller@ntiboilers.com

#### Lakes West

Cory VanVickle  
cvanvickle@ntiboilers.com

#### US West

Shane Frandsen  
sfrandsen@ntiboilers.com



**Products you need  
from people who care**

30 Stonegate Drive,  
Saint John, NB  
E2H 0A4

[ntiboilers.com](http://ntiboilers.com)  
[info@ntiboilers.com](mailto:info@ntiboilers.com)

Toll: 1-800-688-2575  
Direct: 506-657-6000