



Products you need
from people who care

FULL LINE CATALOG

We offer the widest range of high-efficiency hydronic heating and DHW products, designed around your needs.



GAS BOILERS | WATER HEATERS | COMBI FURNACES

For more information contact your local NTI representative or visit ntiboilers.com

TABLE OF CONTENTS

CONDENSING GAS BOILERS

Residential

- 08** TRX Combi
- 10** TRX Heat Only
- 12** FTVN Combi
- 14** FTVN Heat Only
- 16** Vmax Heat Only
- 18** Vmax Plus
- 20** TFT Series

Commercial

- 24** Lx Series
- 26** FTG Series

28 Boiler Selection Guide

WATER HEATING

- 32** Lx-WH Series
- 34** Trin & Stor
- 36** NTI Compact

COMBI FURNACES

- 40** GF200 Combi Furnace

OIL AND WOOD

- 48** Odyssey, Caprice, Triton, WF Series

ABOUT NTI BOILERS

We're NTI.
The partner you can trust.

We offer unmatched product quality and service. Our engineers strive to set new standards for high efficiency gas boilers, water heaters and combi furnaces.

NTI is an industry leader and we have been committed to providing smart climate solutions and personal customer support since we were founded in 1967. Today our head office and manufacturing facility are located on the stunning Drury Cove in Saint John, NB, a location chosen to delight those who visit us.

We are not only pioneers in the development of the most advanced and efficient central heating systems, but at NTI we listen to our customers and use their feedback to guide our innovation. Our knowledgeable, accessible friendly staff are here to support every customer to maximize product performance...and just make their jobs easier.

Acknowledged as a leader in research and product development, NTI manufactures its top-quality, hydronic products in accordance with the most advanced guidelines and industry codes. Its products are developed using state-of-the-art design and testing techniques.

The on-site laboratory and training facilities ensure to maintain NTI commitment to enduring quality, product development and contractor support.

Our customer service team, extended warranty programs and unique training opportunities underline our commitment to you. With NTI, you get quality, North American-made products and unparalleled support.

When you buy an NTI product, peace of mind is included.

We love to hear your feedback! Contact us at

feedback@ntiboilers.com

to provide your opinion on our products and services

The NTI brand is the center of excellence for manufacturing and development for heating products, of the Ariston Thermo Group in North America.

All over the world, Ariston Thermo is synonymous with comfort, energy efficiency and respect for the environment, thanks to its high efficiency products, its plants in compliance with the most advanced production standards and excellent pre- and after-sales customer support services. Our global vision with 9 operating companies, in 40 countries, and 26 production facilities on 15 countries.

The Group has now a leadership position in the global thermal comfort market for domestic, commercial and industrial spaces. The Group counts 7,500 employees and, in 2019, it reached 1.7 billion Euros in sales, produced 8.2 million products and allocated 77 million Euros to investments and R&D.

To know more about Ariston Thermo Group visit aristonthermo.com



Products you need
from people who care

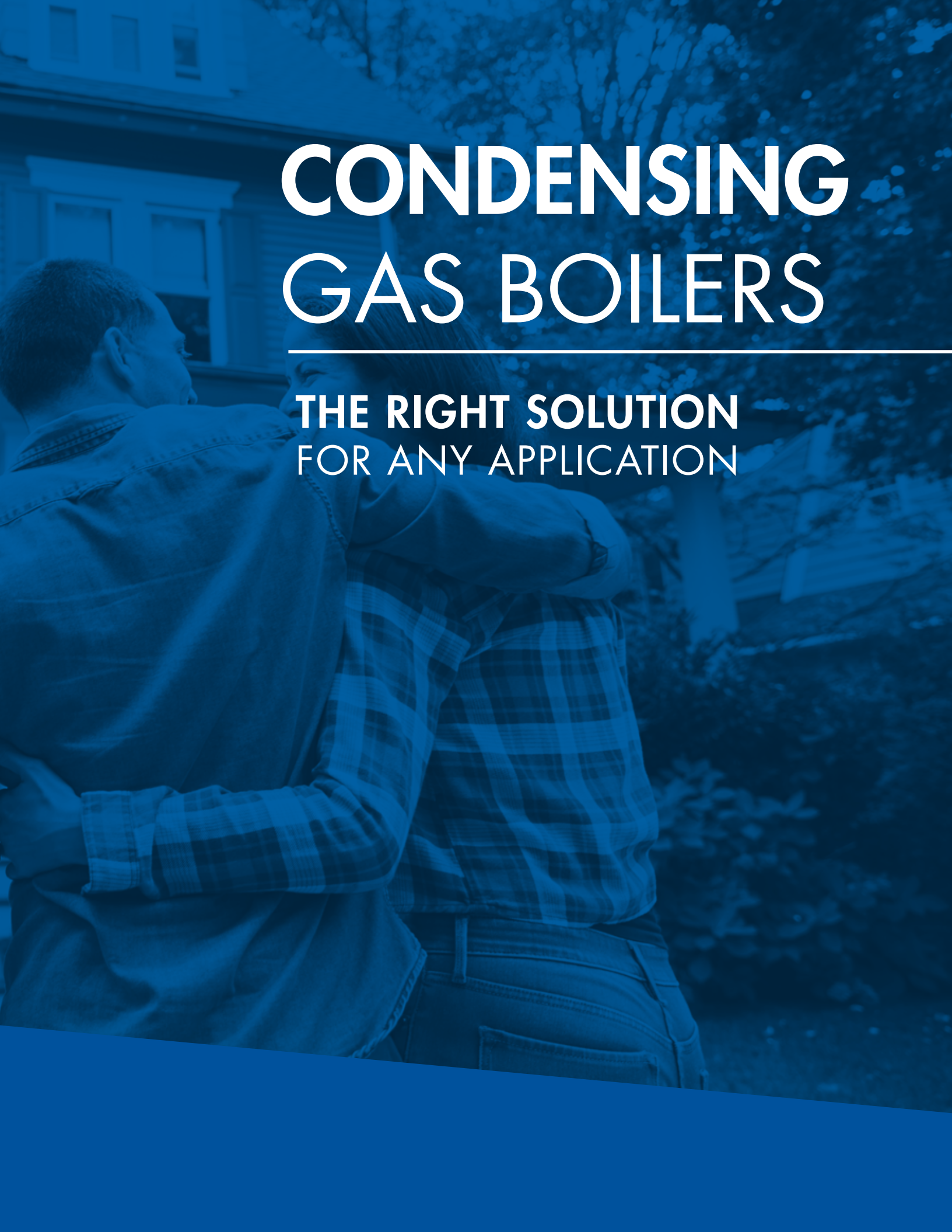

A man and a woman are shown from the back, embracing each other. They are standing in front of a house with visible windows. The entire image is covered with a semi-transparent blue overlay. The text is white and positioned in the upper right area.

CONDENSING GAS BOILERS

**THE RIGHT SOLUTION
FOR ANY APPLICATION**

CONDENSING GAS BOILERS FOR ANY NEED

The NTI gas boilers lineup is the widest in the market, allowing our customers to find the right solution for any installation.

Our offering has been designed with our customers at the core of what we do. We are constantly using feedback from the field to guide our innovation. Over the years we have implemented continuous improvements and new features with one goal: your satisfaction.

Here are few of the features that make our boilers unique and allow us to make a difference when it comes to the installation and maintenance of our products:

Top condensing technology

As one of the pioneers to introduce high efficiency condensing boilers to North America, NTI designs only best in class products.

We use only high quality stainless steel heat exchangers to provide efficiency and reliability at the same time.

**TOP
EFFICIENCY
PERFORMANCES**

Legendary ignition

We are known for our quality startup. All NTI boilers are equipped with an external high-energy spark transformer to ensure proper ignition, each and every time.



120V convenience outlet

Cost effective convenience. Selected NTI products come with a built-in 120V convenience outlet. You can use it to power a condensate pump



Multi-unit cascade function

Connect up to 16 boilers with our integrated cascading function to easily meet even the most demanding installations. No optional devices required.

**INTEGRATED
CASCADE
FUNCTION**

Universal vent connections with embedded test port

Our vent connections include a combustion analyzer test port and can accommodate PVC/CPVC, PP and stainless steel pipes without the need for any adapters.



Outdoor reset sensor included

We make sure you have the right components you need to install our boilers. Our outdoor reset sensor is high quality and field-tested (and is included!).



Note: Not all features available on all products, please consult the model specifications.



TFT

| Supreme Fire Tube

The TFT is the top quality choice for both residential or light commercial applications.

From 60 to 399 MBH



Vmax

| Highest value

Integrated and smart solutions that ensure quick and effective installation.

110 and 154 MBH

PLUS versions with built-in indirect tank



FTVN

| Fire Tube, made simple

High-efficiency, wall-hung fire tube boiler, peace of mind included.

From 85, 150 and 199 MBH Combi
available 110, 150, 199 MBH



TRX

| Superior water tube design, with Wi-Fi

Improved water tube boiler design, with NFI Net connectivity.

From 85-197 MBH

combi available 114, 150, 197 MBH

TRX COMBI

High efficiency heating in DHW and conductivity.

The TRX is the **advanced NTI platform, the new industry standard**, for Combi applications. The improved water flow design, and **Wi-Fi connectivity** makes the TRX the best choice available on the market.

This boiler provides superior performance for both space heating and domestic hot water, providing you all the heat you need in one compact and affordable package.



Available in three sizes:
114, 150 & 197 MBH

95.5% AFUE

Main Features:

- Innovative XTRATECH® Heat exchanger
- Integrated primary pump
- Modulating combustion up to 11:1
- Integrated ECM pump and DHW diverter valve
- Easy service access and quick component connections
- DHW flow switch and serviceable filter
- Vents in PVC, CPVC or Polypropylene. Check with local jurisdictions



The TRX Combi has ample space heating capacity and adds abundant hot water via a high-performance brazed plate heat exchanger.

Wi-Fi gateway to allow the boiler to be connected to the internet and remotely accessible.



Field gas convertible
NG or LP

Outdoor reset

Cascade installation
up to **8**

High-energy spark ignition

Low NOx



Dimensions

A	Central Heating Outlet
B	Domestic Hot Water Outlet
C	3/4" Gas Inlet
D	Domestic Hot Water Inlet
E	Central Heating Inlet
F	Condensate Drain
G	Electrical Connections

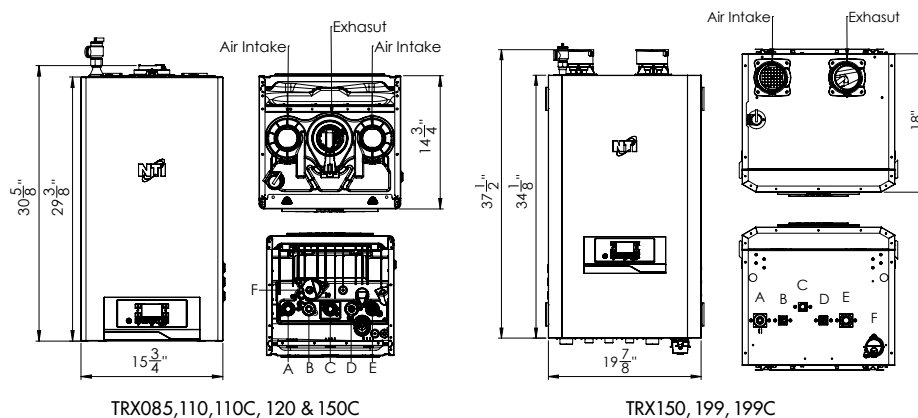

Specifications

	TRX110C	TRX150C	TRX199C
Input Heating	11.2-106 MBH	13.2 - 120 MBH	19.7 - 197 MBH
Input DHW	11.2-114 MBH	13.2 - 150 MBH	
AFUE	95.5%	95%	95%
Heating capacity	98 MBH	111 MBH	184 MBH
Net AHRI Rating	85 MBH	97 MBH	160 MBH
DHW Flow Rate at 77°F T Rise (Combi)	2.7 GPM	3.5 GPM	4.8 GPM
Weight	83.1 lbs	83.6 lbs	135 lbs
Water Content	1.2 gallons		2.7 gallons
Gas Connection	¾ in. NPT Male		
Water Connections (Heating)	1 in. sweat		1 ¼ in. NPT Male
Water Connection (DHW)	¾ in. sweat		¾ in. NPT Male
Air Inlet Connection	2 in. (max 100 ft)		N/A
	3 in. (max 150 ft)		
Flue Connection	2 in. (max 100 ft)		N/A
	3 in. (max 150 ft)		

Accessories:

- TRX series toolbox
- Floor stand
- Low profile vent terminal
- Concentric vent terminal
- Tempering valve
- Boiler corrosion and limescale inhibitor
- Boiler system cleaner
- Water system descaler
- System water temperature sensor
- Room sensor thermostat
- Multizone controller



TRX HEAT ONLY

The next level of water tube boilers.

The TRX is the **advanced NTI platform, and the new industry standard**, for heating boilers. The improved water flow design, and **Wi-Fi connectivity** makes the TRX the best choice available on the market.

This boiler provides both space heating and domestic hot water using an indirect water heater. The TRX provides an internal pump, and diverter valve, eliminating the need for an additional indirect pump and fitting.

All internal components utilize bayonet quick connectors, eliminating the need to braze or solder within the unit. Components can be efficiently serviced. Swing down control box greatly enhances serviceability, making all major components easily accessible.

Available in four sizes:

85, 120, 150 & 197 MBH

95-96% AFUE

Main Features:

- Innovative XTRATECH® Heat exchanger
- Modulating combustion up to 10:1
- Integrated ECM pump and DHW diverter valve
- Easy service access and quick component connections
- Vents in PVC, CPVC or Polypropylene. Check with local jurisdictions



Field gas convertible
NG or LP

Outdoor reset

Cascade installation
up to **8***

High-energy spark ignition

Low NOx



Every unit is equipped with an embedded Wi-Fi gateway to allow the boiler to be connected to the internet and remotely accessible via "NTI Remote Contractor", NTI's web based tele-diagnostic service. The web based service provides registered "NTI Remote Contractors" with an easy way to manage their NTI boiler installations, while providing remote access to the brain of each connected boiler.

Service companies can monitor all their installed Wi-Fi NTI boilers with the NTI Web App. Thanks to the remote diagnostic system and 24/7 remote monitoring, it is now possible to be closer to your customer than ever before.



Dimensions

A	Central Heating Outlet
B	Domestic Hot Water Outlet
C	3/4" Gas Inlet
D	Domestic Hot Water Inlet
E	Central Heating Inlet
F	Condensate Drain
G	Electrical Connections

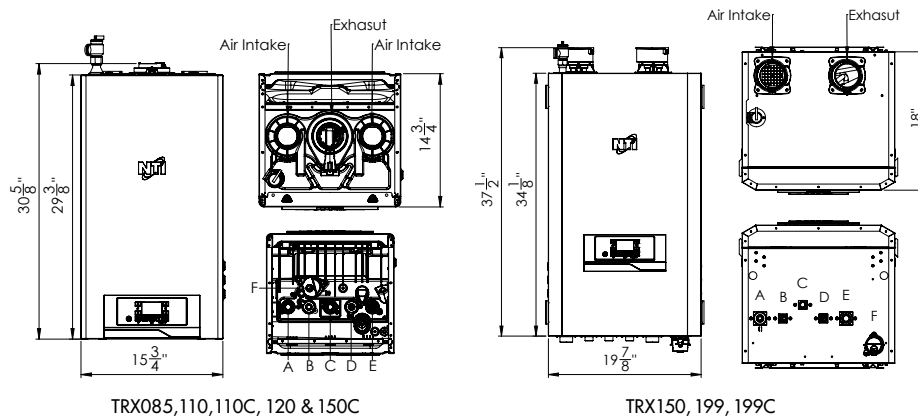

TRX085, 110, 110C, 120 & 150C

TRX150, 199, 199C

Specifications

	TRX085	TRX120	TRX150	TRX199
Input Heating	9.4 - 85 MBH	13.2-120 MBH	15-150 MBH	19.7-197 MBH
Input DHW				
AFUE	96%	95%	95%	95%
Heating capacity	79 MBH	111 MBH	139 MBH	184 MBH
Net AHRI Rating	69 MBH	97 MBH	121 MBH	160 MBH
DHW Flow Rate at 77°F T Rise (Combi)	N/A	N/A	N/A	N/A
Weight	78.5 lbs	84.4 lbs	115 lbs	130 lbs
Water Content	1.1 gallons		2.0 gallons	2.7 gallons
Gas Connection	3/4 in. NPT Male			
Water Connections (Heating)	1 in. sweat		1 1/4 in. NPT Male	
Water Connection (DHW)	3/4 in. sweat		3/4 in. NPT Male	
Air Inlet Connection	2 in. (max 100 ft)			N/A
	3 in. (max 150 ft)			
Flue Connection	2 in. (max 100 ft)			N/A
	3 in. (max 150 ft)			

Accessories:

- TRX series toolbox
- Floor stand
- Low profile vent terminal
- Concentric vent terminal
- Tempering valve
- Boiler corrosion and limescale inhibitor
- Boiler system cleaner
- Water system descaler
- System water temperature sensor
- Room sensor thermostat
- Multizone controller



FTVN COMBI

Fire Tube Boilers Made Simple

The FTVN is a high-efficiency, wall-hung boiler equipped with a **vertical fire tube heat exchanger** made of industry proven 439 stainless steel. NTI's user-friendly programmable display easy to access components and it **easy to install, set up and maintain**, while its unique design enables simpler plumbing layouts to **keep costs well under control**.



Available in three sizes:
110, 150 & 199 MBH

95% AFUE
10:1 Modulation

Main Features:

- Integrated ECM pump and DHW diverter valve
- Fire tube stainless steel heat exchanger
- Integrated easy to service DHW filter
- Universal vent connections with embedded test port
- Wi-Fi on board for remote control and monitoring
- Quick connect components
- Vents in PVC, CPVC or Polypropylene. Check with local jurisdiction.
- Small zone valve systems may not require pump or low loss header



Field gas
convertible
NG or LP



Cascade
installation
up to **8**



The FTVN Combi has ample space heating capacity and adds abundant hot water via a high-performance brazed plate heat exchanger.

Wi-Fi gateway to allow the boiler to be connected to the internet and remotely accessible.



Dimensions

A	Central Heating Outlet
B	DHW Outlet (combi or indirect)
C	Gas Inlet
D	DHW Inlet (combi only)
E	Central Heating Inlet
F	Condensate Drain

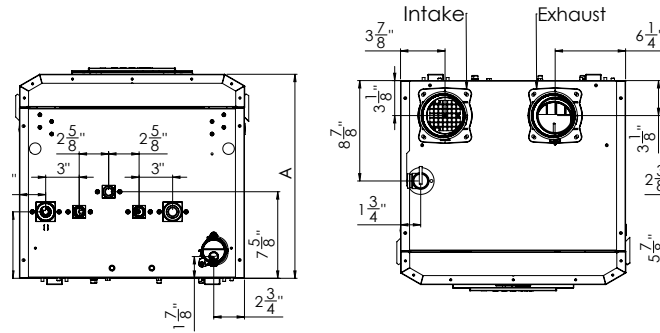

Dimensions (A) - FTVN085 & 110 = 16.5" FTVN150 & 199 = 18"

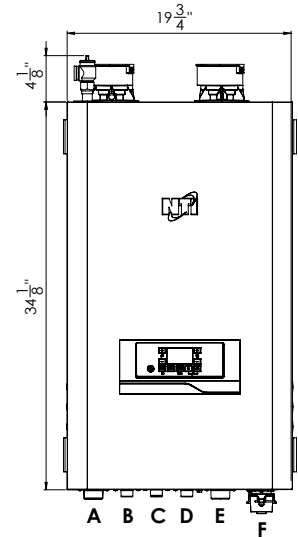

Specifications

	FTVN110C	FTVN150C	FTVN199C
Input Heating MBH	11 - 110	15 - 150	19.9 - 199
Input (DHW Combi)			
AFUE	95%	95%	95%
Heating Capacity (MBH)	101	138	184
Net AHRI Rating (MBH)	88	120	160
Combi Water Flow at 77° FT Rise	2.7 GPM	3.6 GPM	4.8 GPM
Weight (lbs)	95	106	117
Water Content (Gallons)	1.5		2.8
Water Connections (Heating)	1-1/4" NPT-M		
Water Connections (DHW)	3/4" NPT-M		
2" Inlet & Exhaust Distance	100' max		N/A
3" Inlet & Exhaust Distance	150' max		150' max
Gas Connection All Models	3/4" Male		

Accessories:

- FTVN Series tool box
- Floor stand
- Low profile vent terminal
- Concentric vent terminal
- Tempering valve
- Boiler corrosion and limescale inhibitor
- Boiler system cleaner
- Boiler system descaler
- System water temperature sensor



FTVN HEAT ONLY

Fire Tube Boilers Made Simple

The FTVN is a high-efficiency, wall-hung boiler equipped with a **vertical fire tube heat exchanger** made of industry proven 439 stainless steel. NTI's user-friendly programmable display and easy to access components makes it **easy to install, set up and maintain**, while its unique design enables simpler plumbing layouts to **keep costs well under control**.

The FTVN features a powerful high efficiency ECM pump, to quietly circulate water through the boiler and boiler primary loop, or boiler and indirect water heater loop – AN EXTERNAL DHW PUMP IS NOT REQUIRED.

The FTVN has been designed with service in mind. The components are each easily removable, and the space within the cabinet has been maximized so that your hard working hands have space to work. The swing down control box also enhances serviceability, making all major components easily accessible.

Available in three sizes:
85, 110, 150 & 199 MBH

96% AFUE
10:1 Modulation

Main Features:

- Fire tube stainless steel heat exchanger
- Quick connect components
- Universal vent connections with embedded test port
- Vents in PVC, CPVC or Polypropylene. Check with local jurisdiction.



Field gas
convertible
NG or LP

Outdoor reset

Cascade
installation
up to **16**

High-energy
spark ignition

Low NOx



**OPTIONAL FLOOR
MOUNT KIT #86998**

Every unit is equipped with an embedded Wi-Fi gateway to allow the boiler to be connected to the internet and remotely accessible via "NTI Remote Contractor", NTI's web based tediagnostic service. The web based service provides registered "NTI Remote Contractors" with an easy way to manage their NTI boiler installations, while providing remote access to the brain of each connected boiler.

Service companies can monitor all their installed Wi-Fi NTI boilers with the NTI Web App. Thanks to the remote diagnostic system and 24/7 remote monitoring, it is now possible to be closer to your customer than ever before.



Dimensions

A	Central Heating Outlet
B	DHW Outlet (combi or indirect)
C	Gas Inlet
D	DHW Inlet (combi only)
E	Central Heating Inlet
F	Condensate Drain

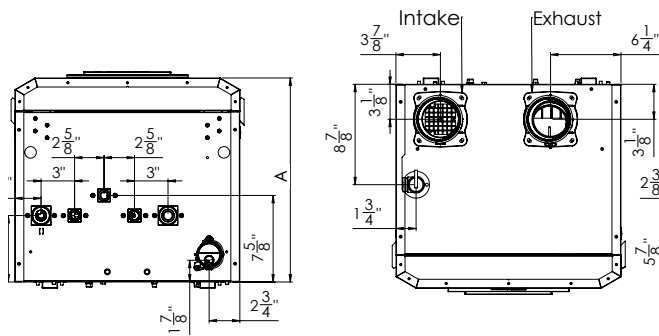

Dimensions (A) - FTVN085 & 110 = 16.5" FTVN150 & 199 = 18"

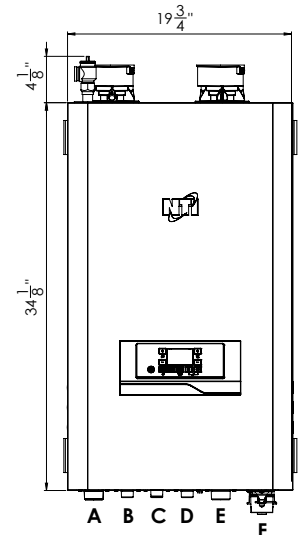

Specifications

	FTVN085	FTVN110	FTVN150	FTVN199
Input Heating MBH	8.5 - 85	11 - 110	15 - 150	19.9 - 199
Input (DHW Combi)				
AFUE	96%	95%	95%	95%
Heating Capacity (MBH)	79	101	138	184
Net AHRI Rating (MBH)	69	88	120	160
Combi Water Flow at 77° FT Rise	N/A			
Weight (lbs)	95	95	105	116
Water Content (Gallons)	1.4	1.4	2.0	2.8
Water Connections (Heating)	1-1/4" NPT-M			
Water Connections (DHW)	3/4" NPT-M			
2" Inlet & Exhaust Distance	100' max			N/A
3" Inlet & Exhaust Distance	150' max			
Gas Connection All Models	3/4" Male			

Accessories:

- FTVN Series tool box
- Floor stand
- Low profile vent terminal
- Concentric vent terminal
- Boiler corrosion and limescale inhibitor
- Boiler system cleaner
- Boiler system descaler
- System water temperature sensor



Vmax HEAT ONLY

High value integrated solutions that makes life easy

The Vmax Series is equipped with a high-performance down-fired fire tube stainless steel heat exchanger and have been designed to make installation, setup, and service easy. The dedicated indirect tank connections and integrated primary loop pump make the Vmax Series unique in the boiler industry, setting a new standard in terms of ease of installation and peace of mind. **Integrated and smart solutions** that ensure quick and effective installation, even for complex applications.

Available in two sizes:
110 MBH & 154 MBH

95% AFUE

Main Features:

- Built-in primary loop and circulating pump
- High performance fire tube stainless steel heat exchanger
- Vents in PVC, CPVC or Polypropylene. Check with local jurisdiction.
- Dedicated indirect tank connections
- Universal vent connections with embedded test port
- Easy to program display
- Quick connect components



Field gas convertible
NG or LP

Outdoor reset

Cascade installation
up to **16**

High-energy spark ignition

120V Convenience Outlet



Dimensions

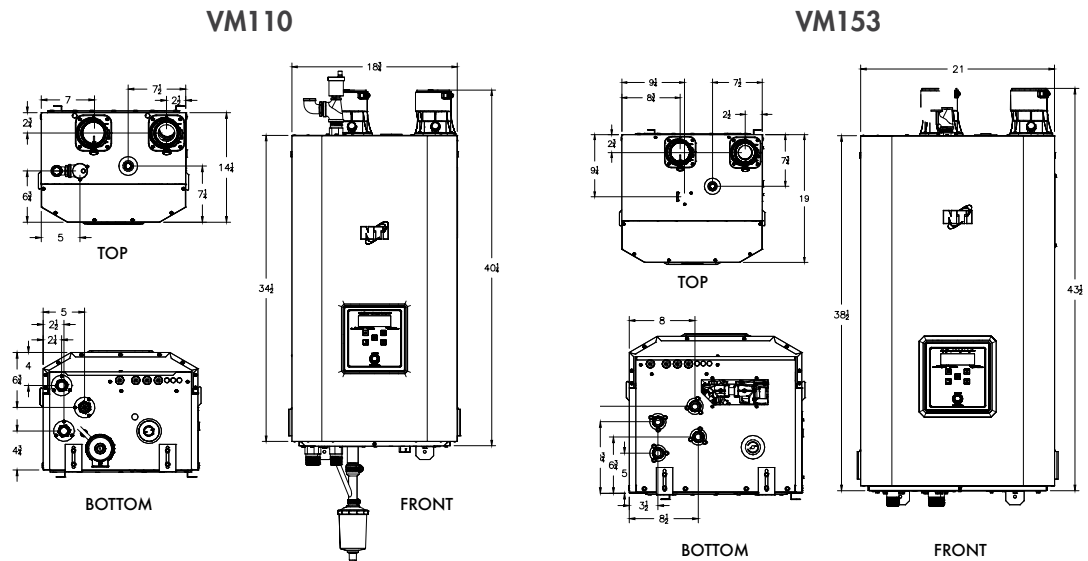

Specifications

		VM110	VM153
Input Power	Natural Gas	13.8 - 110 MBH	15.4 - 154 MBH
	Propane		
AFUE		95%	
Heating capacity		101 MBH	141 MBH
Net AHRI Rating		88 MBH	122 MBH
Installation type		Indoor Wall Hung (rack available for floor standing installation)	
Weight		110 lb	135 lb
Gas connection		½ in NPT female	
Water connections		1 in NPT male	
Air Inlet		2 in (max 100 ft), 3 in (max 150 ft)	3 in (max 150 ft)
Flue		2 in (max 100 ft), 3 in (max 150 ft)	3 in (max 150 ft)

Accessories:

- Vmax Series tool box
- Floor stand
- Low profile vent terminal
- Concentric vent terminal
- Boiler corrosion and limescale inhibitor
- Boiler system cleaner
- Boiler system descaler
- System water temperature sensor



Vmax PLUS

All the heat you need with unparalleled DHW comfort

The Vmax Plus is more than a Combi boiler. On the hot water side, it features an internal 16 gallon indirect tank to provide the best comfort experience to homeowners.

Forget about cold water sandwich and long waiting time: with Vmax Plus you will get plenty of hot water with the minimum effort. Comfort and dependability merge together, thanks to the stainless steel down-fired fire tube heat exchanger which ensures long product life and enduring performances.

The integrated smart solutions included in the Vmax Plus represent a unique offering in the market, **designed to make installation easy also in complex installations.**

Available in two sizes:
110 MBH & 154 MBH

95% AFUE

Main Features:

- Built-in primary loop and circulating pump
- High performance fire tube stainless steel heat exchanger
- Integrated stainless steel 16 gallon indirect tank
- Universal vent connections with embedded test port
- Easy to program display
- Quick connect components
- Vents in PVC, CPVC or Polypropylene. Check with local jurisdiction.



Field gas convertible
NG or LP

Outdoor reset

Cascade installation
up to **16**

High-energy
spark ignition

120V
Convenience
Outlet



Dimensions

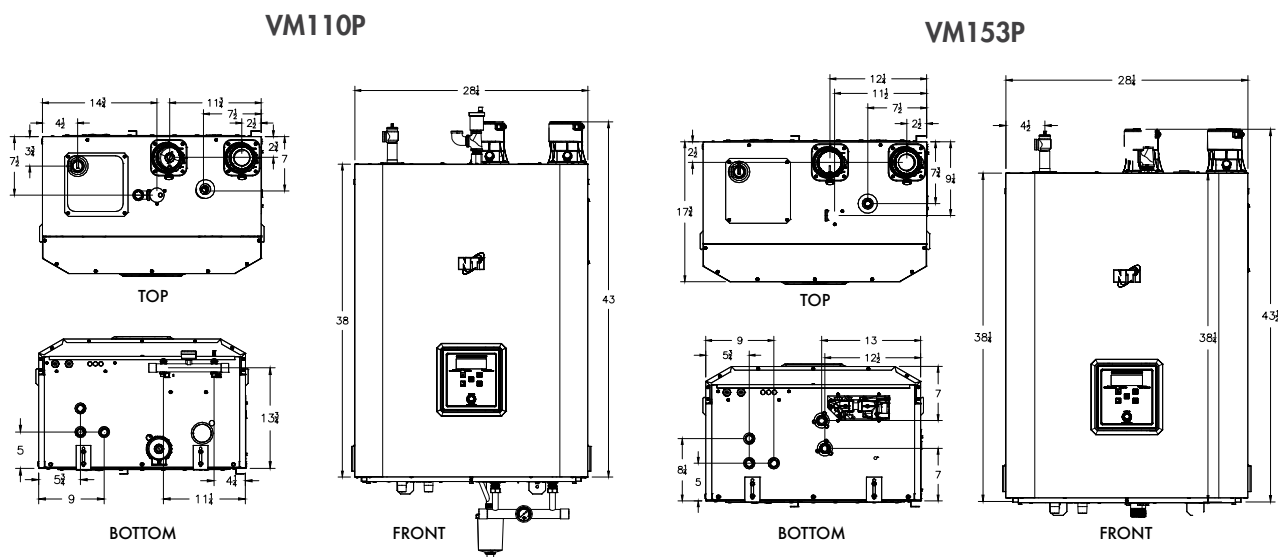

Specifications

		VM110P	VM153P
Input Power	DHW	13.8 - 110 MBH	15.4 - 154 MBH
	Heating	13.8 - 110 MBH	15.4 - 154 MBH
AFUE		95%	
Heating capacity		101 MBH	141 MBH
Net AHRI Rating		88 MBH	122 MBH
DHW Flow Rate at 77°F T Rise		2.6 GPM	3.6 GPM
Installation type		Indoor Wall Hung (rack available for floor standing installation)	
Weight		115 lb	140 lb
Gas connection		1/2 in NPT female	
Water connections		1 in female (sweat joint)	1 in NPT male
Air Inlet		2 in (max 100 ft), 3 in (max 150 ft)	3 in (max 150 ft)
Flue		2 in (max 100 ft), 3 in (max 150 ft)	3 in (max 150 ft)
DHW		3/4 in NPT male	

Accessories:

- Vmax Series tool box
- Floor stand
- Low profile vent terminal
- Concentric vent terminal
- Boiler corrosion and limescale inhibitor
- Boiler system cleaner
- Boiler system descaler
- System water temperature sensor



TFT SERIES

The supreme Fire Tube Boiler from 60 to 399 MBH

The TFT is the top quality choice for both residential or light commercial applications.

The high performance stainless steel down-fired fire tube heat exchanger and the **top and bottom stainless steel piping connections, offer supreme durability and flexibility of installation.**

The **touch screen display is user-friendly** and enables countless advanced settings, including cascade management and advanced boiler settings. The TFT reigns supreme with its **unique mix of outstanding performances and legendary reliability.**

Available in eight sizes ranging from: **60 MBH to 399 MBH**

95% AFUE

Main Features:

- Touch screen intuitive display
- High performance fire tube stainless steel heat exchanger
- Integrated low water cut-off
- Stainless steel internal piping and venting
- Top and bottom water connections
- Advanced cascade settings
- Vents in PVC, CPVC or Polypropylene. Check with local jurisdiction.



Field gas convertible
NG or LP

Outdoor reset

Cascade installation
up to **8**

High-energy spark ignition

120V
Convenience Outlet



Dimensions

FRONT

DIM	60-110	154	201	285	340-399
i	33 1/2"	33 1/2"	33 1/2"	33 1/2"	36 1/2"
j	19 3/4"	19 3/4"	19 3/4"	21 1/4"	25"
k	37 3/4"	38 1/2"	37 3/4"	37 3/4"	40 1/2"

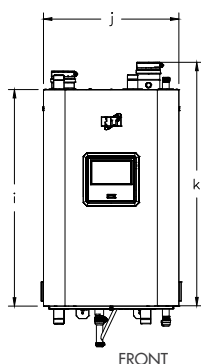

TOP

DIM	60-110	154	201	285	340-399
a	6 3/4"	10 1/2"	10 1/2"	12 1/2"	14"
b	2 3/4"	2 3/4"	2 3/4"	3"	5 1/4"
c	6"	6"	2 1/2"	2 1/2"	20 3/4"
d	17"	15 1/2"	3 1/4"	3"	22 1/2"
e	17 3/4"	17"	3"	7 1/2"	20 3/4"
f	11 3/4"	16 1/2"	3"	4 3/4"	21"
g	1 1/2"	2"	1 1/2"	2"	2 3/4"
h	7 1/2"	10 1/2"	6"	6 1/4"	10 1/4"

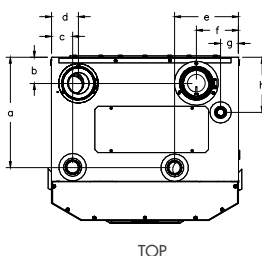

BOTTOM

DIM	60-110	154	201	285	340-399
l	2"	2 3/4"	2 1/4"	2"	20 3/4"
m	10"	13 1/2"	13"	12 1/2"	14"
n	5 1/2"	8"	13 1/4"	13"	14"
o	7 1/2"	10 1/2"	6 1/2"	6 1/4"	12"
p	1 1/2"	2"	1 1/2"	2"	1 1/2"
q	17 3/4"	17"	3"	5 1/4"	19 1/2"

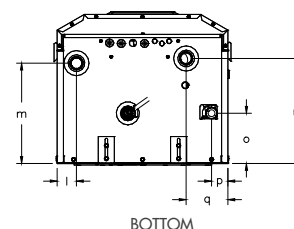

Specifications

		TFT60	TFT85	TFT110	TFT154	TFT201	TFT285	TFT340	TFT399
Input Power	NG	17 - 60 MBH	17 - 85 MBH	21.6 - 108 MBH	15.4 - 154 MBH	20 - 200 MBH	28.5 - 285 MBH	39.9 - 340 MBH	39.9 - 399 MBH
	LP	17.6 - 65 MBH	17.6 - 88 MBH	22.6 - 113 MBH					
AFUE		95%						95.4% Thermal Efficiency	
Heating capacity		56 MBH	78 MBH	99 MBH	141 MBH	185 MBH	263 MBH	324 MBH	380 MBH
Net AHRI Rating		48 MBH	68 MBH	86 MBH	122 MBH	160 MBH	228 MBH	282 MBH	330 MBH
Installation type		Indoor Wall Hung (rack available for floor standing installation)							
Weight		128 lb	128 lb	128 lb	170 lb	200 lb	200 lb	237 lb	247 lb
Gas connection		½ in NPT female					¾ in NPT male		
Water conn.		1 in NPT male				1 ¼ in NPT male		1 ½ in NPT male	
Air Inlet		2 in (max 100 ft*), 3 in (max 150 ft)			3 in (max 150 ft)			4 in (max 100 ft)	
Flue		2 in (max 100 ft*), 3 in (max 150 ft)			3 in (max 150 ft)			4 in (max 100 ft)	

* for LP: TFT60-85 max 35 ft, TFT110 max 25 ft

Accessories:

- TFT Series tool box
- Floor stand
- Low profile vent terminal
- Concentric vent terminal
- Common venting for TFT340/399
- Boiler corrosion and limescale inhibitor
- Boiler system cleaner
- Boiler system descaler
- System water temperature sensor





Products you need
from people who care



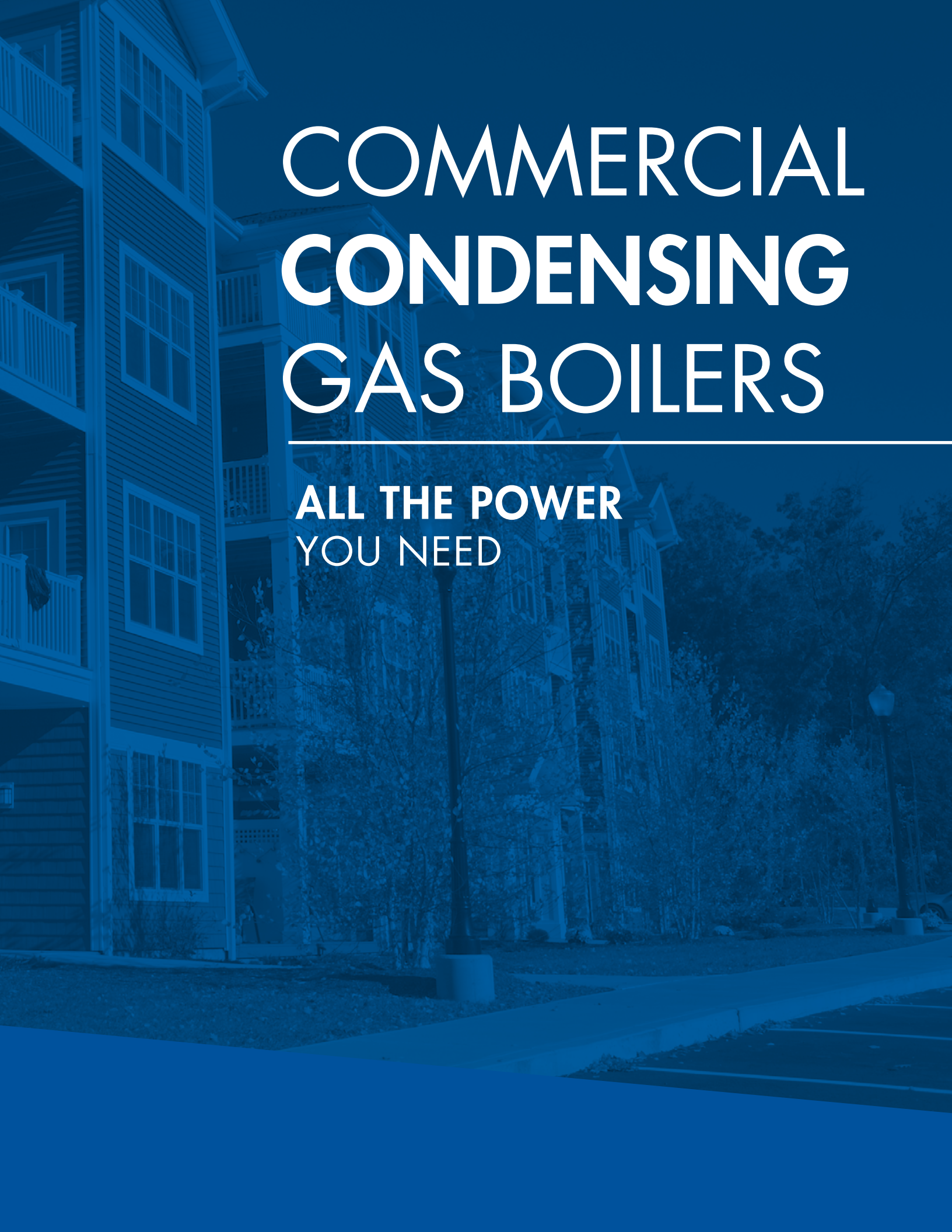

COMMERCIAL CONDENSING GAS BOILERS

**ALL THE POWER
YOU NEED**

LX SERIES

When you need more power
we've got you covered

For light to heavy commercial applications, the Lx is the ideal option, with its easy to clean, **high power stainless steel heat exchanger**. The Lx Series boilers are designed for floor standing installation and can be also mounted wall-hung up to 399 MBH.

Its easy to access electronic board and well accessible components make it easy service and regular maintenance.

Cascade management and other outstanding programming features can be easily controlled by the intuitive touch screen display.

Available in eight sizes
ranging from: **200 MBH**
to **800 MBH**

94% Thermal Efficiency

Main Features:

- Touch screen intuitive display
- Easy cleaning stainless steel heat exchanger
- Wall hung kit included for Lx200-400
- High power sizes up to 800 MBH
- Easy access to the display and internal components
- Advanced cascade settings
- Vents in PVC, CPVC or Polypropylene. Check with local jurisdiction.



Low NOx

Field gas
convertible up to 500
NG or LP

Outdoor reset

Cascade
installation
up to **8**

High-energy
spark ignition



Dimensions

Lx300-400

FRONT

DIM	300	400
a	39 3/4"	39 3/4"
b	17 1/4"	17 1/2"
c	36 1/4"	36 1/4"
d	11 3/4"	11 3/4"
e	9 1/2"	9 1/2"

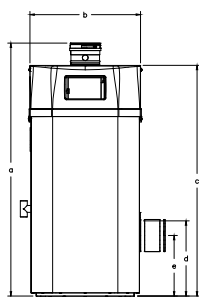

FRONT

TOP

DIM	300	400
f	21 1/2"	24"
g	4 1/4"	4 1/4"
h	8 1/2"	8 1/2"
i	4 1/4"	4 1/4"
j	10 3/4"	16 1/2"

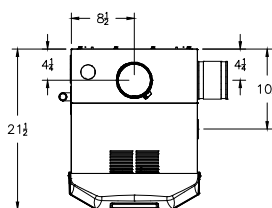

TOP

SIDE

DIM	300	400
k	24 1/2"	24 3/4"
l	2 3/4"	3 1/4"
m	7"	9 1/2"

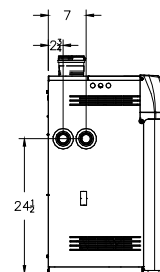

SIDE

*Please refer to Lx Series Brouchure for dimension of Lx150-200 and Lx500-800

Specifications*

		Lx200	Lx300	Lx400	Lx500	Lx600	Lx800
Input Power	Natural Gas	25 - 199 MBH	55 - 275 MBH	75 - 399 MBH	100 - 500 MBH	120 - 600 MBH	160 - 800 MBH
	Propane					N/A	N/A
AFUE		93.5%	93.7%	94% Thermal Efficiency			
Heating capacity		181 MBH	251 MBH	375 MBH	470 MBH	564 MBH	752 MBH
Net AHRI Rating		157 MBH	218 MBH	326 MBH	409 MBH	490 MBH	654 MBH
Installation type		Indoor Floor Standing (Wall Hung kit included)			Indoor Floor Standing		
Weight		125 lb	180 lb	225 lb	320 lb	380 lb	475 lb
Gas connection		½ in NPT female	½ in NPT female	¾ in NPT female	¾ in NPT female	1 in NPT male	
Water connections		1 in NPT female	1 ¼ in NPT female	1 ¼ in NPT female	2 in NPT female		
Air Inlet		3 in (max 105 ft)	4 in (max 100 ft)				6 in (max 100 ft)
Flue		3 in (max 105 ft)	4 in (max 100 ft)				6 in (max 100 ft)

* Lx150 and Lx700 also available. Please refer to Lx Series Brochure for specifications

Accessories:

- Lx Series tool box
- Low profile vent terminal
- Concentric vent terminal
- Boiler corrosion and limescale inhibitor
- Boiler system cleaner
- Boiler system descaler
- System water temperature sensor



FTG SERIES

All the power you need for any commercial applications

The FTG is a **stainless steel high efficiency fire tube commercial boiler** that ranges from 800 MBH to 2,350 MBH.

The FTG features a dynamic **multiple heat exchanger design**, with single blower, gas valve and burner. The **user-friendly touch screen display** and **advanced programmable features** make it the ideal choice for dependable and highly demanding commercial applications.

The FTG Series has been designed to provide a reliable source of heat at the maximum energy efficiency levels, without compromises.

Available in six sizes ranging from: **800 MBH to 2,350 MBH**

Up to **96%** Thermal Efficiency

Main Features:

- Touch screen intuitive display
- High performance fire tube stainless steel heat exchanger
- Integrated low water cut-off
- Integrated combustion air filter
- CSD-1 compliant
- Advanced cascade settings
- Sealed cabinet
- Vents in PVC, CPVC or Polypropylene. Check with local jurisdiction.



Low NOx

Field gas convertible
NG or LP

Outdoor reset

Cascade installation
up to **8**

High-energy spark ignition

120V
Convenience Outlet



TOP

Dimensions

FRONT

DIM	600-800	1200	1400	2000	2200-2400
k	68 1/4"	67"	67"	67 1/2"	67 1/2"
l	34"	34"	34"	34"	34"
m	61 3/4"	61"	61"	61 1/2"	61 1/2"

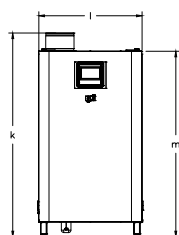

FRONT

SIDE

DIM	600-800	1200	1400	2000	2200-2400
n	17 1/4"	67"	67"	67 1/2"	67 1/2"
o	44 1/2"	44 1/4"	44 1/4"	44 3/4"	44 3/4"
p	54 1/2"	54 1/4"	54 1/2"	53 1/2"	53 1/2"

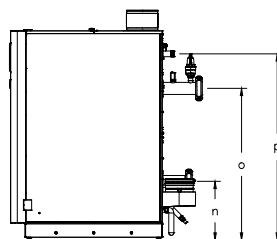

SIDE

DIM	600-800	1200	1400	2000	2200-2400
a	8 1/2"	11 1/2"	11 1/2"	11 3/4"	11 3/4"
b	8 1/2"	8 3/4"	8 3/4"	8 1/2"	8 1/2"
c	4"	5 1/2"	5 1/2"	5 3/4"	5 3/4"
d	7"	7"	7"	7"	7"
e	12 1/2"	12 1/4"	12 1/4"	12"	12"
f	13"	13"	13"	13"	13"
g	17"	17"	17"	17"	17"
h	11"	11"	11"	11"	11"
i	5"	5"	5"	5"	5"
j	29 1/4"	44 1/4"	44 1/4"	60 1/4"	60 1/4"

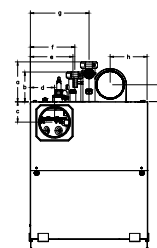

TOP

Specifications*

		FTG800	FTG1200	FTG1400	FTG2000	FTG2200	FTG2400
Input Power	Natural Gas	80 - 800 MBH	120 - 1,200 MBH	140 - 1,400 MBH	235 - 2,000 MBH	235 - 2,200 MBH	235 - 2,350 MBH
	Propane						
Thermal Efficiency		95%	96.1%	96%	96%	95.6%	95.2%
Heating capacity		760 MBH	1,153 MBH	1,344 MBH	1,920 MBH	2,103 MBH	2,237 MBH
Net AHRI Rating		660 MBH	1,003 MBH	1,169 MBH	1,670 MBH	1,829 MBH	1,945 MBH
Installation type		Indoor Floor Standing					
Weight		780 lb	1,210 lb		1,710 lb		
Gas connection		1 in NPT female	1 1/4 in NPT female		1 1/2 in NPT male		
Water conn.	Inlet	3 in groove joint					
	Outlet	2 in groove joint			3 in groove joint		
Air Inlet		6 in (max 150 ft)			8 in (max 150 ft)		
Flue		6 in (max 150 ft)			8 in (max 150 ft)		

* FTG600 also available. Please refer to FTG Series Brochure for specifications

Accessories:

- FTG Series tool box
- Low profile vent terminal
- Concentric vent terminal
- Boiler corrosion and limescale inhibitor
- Boiler system cleaner
- Boiler system descaler
- System water temperature sensor



CONDENSING GAS BOILER SELECTION

This boiler selection guide is meant to provide a quick overview of the NTI wide product range. For detailed information about a specific product. Please see relevant product brochures and manuals or visit ntiboilers.com

	HEAT ONLY			
	TRX	FTVN	Vmax	TFT
Max Power Input	85-197 MBH	85-199 MBH	110 - 154 MBH	60 - 399 MBH
Turn Down ratio	up to 10:1	10:1	up to 10:1	up to 10:1
Efficiency	95% AFUE	up to 96% AFUE	95% AFUE	95% AFUE
Heat Exchanger	Stainless Steel Water Tube	Stainless Steel Fire Tube	Stainless Steel Fire Tube	Stainless Steel Fire Tube
Boiler Controller	NTI-Net Control	NTI-Net Control	NTI Smart Push Button	NTI iFLEX Touch Screen
Combustion air intake	Sealed Cabinet	Sealed Cabinet	Direct connection	Direct connection
Internal piping material	Copper	Copper	Copper	Stainless Steel
Water connections	Bottom	Bottom	Bottom	Top and Bottom
Cascade installation	√ (up to 8)	√ (up to 8)	√ (up to 16)	√ (up to 8)
Propane conversion kit	√	√	√	√
Outdoor reset	√	√	√	√
Integrated Low Water Cut-off				√
Integrated primary Loop			√	
Integrated primary loop pump	√	√	√	
Integrated indirect tank circulation pump	√	√	√ (on VM153 only)	
Integrated indirect tank				
Dedicated indirect tank connections	√	√	√	√
High Voltage Spark Ignition	√	√	√	√
Integrated 120 V condensate pump receptacle			√	√
Warranty	Parts	5y	5y	5y
	Heat Exchanger	15 years	15 years	Limited Lifetime
Ideal for	Cost effective and reliable space heating residential applications	Cost effective and reliable fire tube space heating residential applications	High value integrated components Fire Tube boiler for residential heating applications	High end Fire Tube boiler for residential or light commercial applications



Products you need
from people who care

		COMBI		
Lx	FTG	TRX COMBI	FTVN COMBI	VMAX PLUS
150 - 800 MBH	800 - 2,400 MBH	DHW: 114-197 MBH Heating: 106-197 MBH	110-199 MBH	110 - 154 MBH
up to 8:1	up to 10:1	up to 11:1	10:1	up to 10:1
93.5% AFUE / 94% T.E.	96% T.E.	95% AFUE	95% AFUE	95% AFUE
Stainless Steel Water Tube	Stainless Steel Fire Tube	Stainless Steel Water Tube	Stainless Steel Fire Tube	Stainless Steel Fire Tube
NTI ifLEX Touch Screen	NTI ifLEX Touch Screen	NTI-Net Control	NTI-Net Control	NTI Smart Push Button
Direct connection	Sealed Cabinet	Sealed Cabinet	Sealed Cabinet	Direct connection
N/A	N/A	Copper	Copper	Copper
Left	Rear	Bottom	Bottom	Bottom
√ (up to 8)	√ (up to 8)	√ (up to 8)	√ (up to 8)	√ (up to 16)
√ (except Lx600 - Lx800)	√	√	√	√
√	√	√	√	√
	√			
				√ (low loss header included for VM110P)
		√	√	√
		N/A	N/A	√
		N/A	N/A	√ (16 gal)
		N/A	N/A	N/A
√	√	√	√	√
	√			√
5y	5y	5y	5y	5y
Limited Lifetime	Limited Lifetime	15 years	15 years	Limited Lifetime
Light to heavy commercial applications	Fire Tube boiler for commercial applications of any kind	Cost effective and reliable combination residential boiler	Cost effective and reliable fire tube combination residential boiler	Combi application with unparalleled DHW comfort



Products you need
from people who care





WATER HEATING

**ENDLESS HOT WATER
FOR ANY APPLICATION**

LX-WH SERIES

Gas condensing volume water heater for commercial use

The Lx-WH combines quality with unmatched efficiency while providing a tremendous output capacity. The **high power stainless steel heat exchanger** is easy to clean and install. The **touch screen display is user friendly**, and the Lx-WH offers **advanced programming features**.

Available in six sizes
ranging from: **199 MBH**
to **800 MBH**

96%
Thermal Efficiency

Main Features:

- Touch screen intuitive display
- Easy to clean stainless-steel heat exchanger
- Floor or wall-mount options
- Ideal coupling with Trin&Stor Storage tanks
- High power sizes up to 800 MBH
- Easy access to the display and internal components
- Advanced cascade settings



Field gas
convertible up to 500
NG or LP

Outdoor reset

Cascade
installation
up to **8**

High-energy
spark ignition



Dimensions

FRONT		
DIM	300	400
a	39 ¾"	39 ¾"
b	17 ¼"	17 ½"
c	36 ¼"	36 ¼"
d	11 ¾"	11 ¾"
e	9 ½"	9 ½"

TOP		
DIM	300	400
f	21 ½"	24"
g	4 ¼"	4 ¼"
h	8 ½"	8 ½"
i	4 ¼"	4 ¼"
j	10 ¾"	16 ½"

SIDE		
DIM	300	400
k	24 ½"	24 ¼"
l	2 ¾"	3 ¼"
m	7"	9 ½"

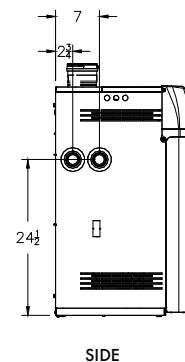
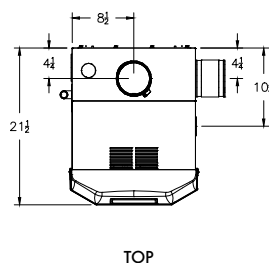
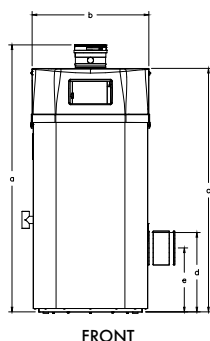

Specifications*

		Lx200WH	Lx300WH	Lx400WH	Lx500WH	Lx600WH	Lx800WH
Input Power	Natural Gas	25 - 199 MBH	55 - 275 MBH	75 - 399 MBH	100 - 500 MBH	120 - 600 MBH	160 - 800 MBH
	Propane					N/A	N/A
GPH at 100°F T Rise		229 GPH	317 GPH	460 GPH	576 GPH	691 GPH	922 GPH
Thermal Efficiency		96%					
Installation type		Indoor Floor Standing (Wall Hung kit included)			Indoor Floor Standing		
Weight		125 lb	180 lb	225 lb	320 lb	380 lb	475 lb
Gas connection		½ in NPT female	½ in NPT female	¾ in NPT female	¾ in NPT female	1 in NPT male	
Water connections		1 in NPT female	1 in NPT female	1 ¼ in NPT female	2 in NPT female		
Air Inlet		3 in (max 105 ft)	4 in (max 100 ft)				6 in (max 100 ft)
Flue		3 in (max 105 ft) 4 in (max 105 ft)	4 in (max 100 ft)				6 in (max 100 ft)

Lx700 WH also available

Accessories:

- Lx-WH Series tool box
- Floor stand
- Low profile vent terminal
- Concentric vent terminal
- Tempering valve
- Boiler system cleaner
- Boiler system descaler
- System water temperature sensor



TRIN & STOR TANKS

Highest quality stainless steel indirect water heaters and storage tanks

The Trin & Stor passivated steel **storage tanks are renowned for maximum resistance to corrosion, which increases their longevity.** Their **high-quality construction and components** make these storage tanks a popular product, and they come in a **wide range of sizes to fit any need.**

Available in three lines with sizes ranging from:
40 gallons to 120 gallons

Main Features:

- Stainless steel passivated construction
- Simple and quick aquastat connection
- Lead free
- High accuracy tank sensor
- Widest product range from 40 to 120 gallons
- Highest quality construction

S/S
TANK



AQUASTAT
CONNECTION

TANK
SENSOR

C US
Low Lead Content

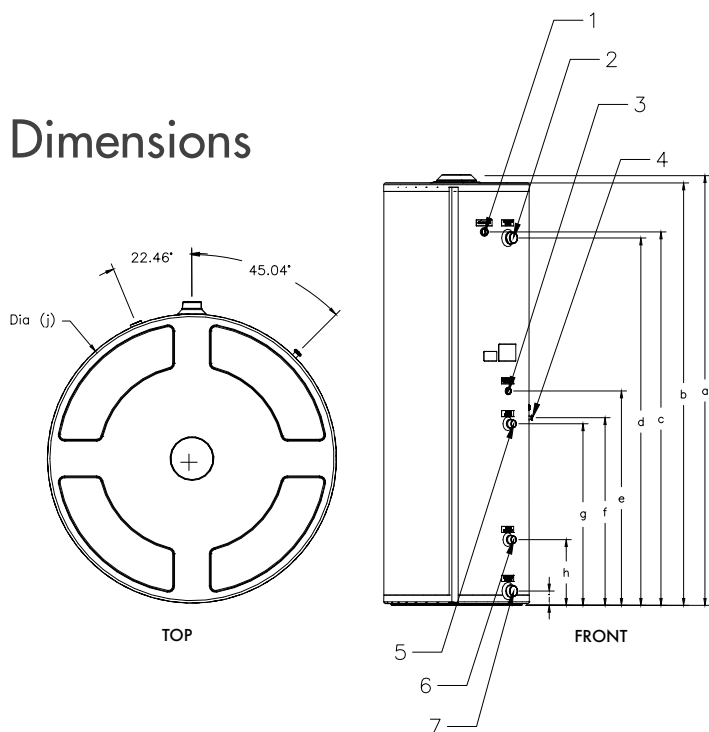

Dimensions



DIM	S40	S50	S65	S80	S120	ST80	ST120
a	56"	49"	70 1/2"	70 1/4"	—	—	—
b	54 3/4"	47 3/4"	69 1/4"	69"	64 3/4"	72 3/4"	65"
c	46 3/4"	39 3/4"	60 1/4"	61"	53 1/2"	59 1/2"	52 1/2"
d	46 3/4"	39 1/2"	60 1/4"	60"	53 1/4"	59 1/2"	52 1/2"
e	29"	29 1/2"	32 1/2"	35"	44 1/2"	10 3/4"	12 3/4"
f	25"	26"	27"	29 1/2"	40 1/2"	—	—
g	26"	27"	28"	30 1/2"	41 1/2"	11 1/2"	13 1/4"
h	9 1/2"	10"	10 1/4"	10 3/4"	12 1/4"	—	—
i	2"	2"	2"	2 1/2"	2 1/2"	2 1/2"	2 1/2"
j	20"	24"	22"	24"	29"	24"	29"
1	3/4" F	3/4" F	3/4" F	3/4" F	3/4" F	1" F	1" F
2	1" M	1"	1"	1 1/2"	1 1/2"	1 1/2"	1 1/2"
3	3/4" F	3/4" F	3/4" F	3/4" F	3/4" F	1 1/2" M	1 1/2" M
4	1" M	1" M	1" M	1" M	1" M	—	—
5	1" M	1" M	1" M	1" M	1" M	—	—
6	1" M	1"	1"	1 1/2"	1 1/2"	1 1/2"	1 1/2"
7	Well	Well	Well	Well	Well	Well	Well

Specifications

	INDIRECT WATER HEATERS						
	S40	S50	S65	S80	S120	ST80	ST120
Storage capacity	40 gal	53 gal	65 gal	79 gal	119 gal	79 gal	119 gal
Tank material	Stainless Steel					Stainless Steel	
Coil material	Stainless Steel					N/A	
Insulation	EPS Foam					EPS Foam	
Weight empty	71	90	100	115	157	160	175
Weight filled	485	655	800	995	1,275	1,040	1,293
Continuous recovery	140°F	228 gal	238 gal	288 gal	356 gal	485 gal	N/A
	115°F	303 gal	313 gal	401 gal	468 gal	636 gal	N/A
Boiler output	146 MBH	146 MBH	210 MBH	210 MBH	290 MBH	N/A	N/A
Coil flow rate	6.9 GPM	6.9 GPM	10.4 GPM	10.4 GPM	13.6 GPM	N/A	N/A
Coil pressure drop	0.5 PSI	0.5 PSI	1.5 PSI	1.5 PSI	2.1 PSI	N/A	N/A
Hour 1 recovery	140°F	196 GPH	196 GPH	292 GPH	292 GPH	392 GPH	N/A
	115°F	271 GPH	271 GPH	404 GPH	404 GPH	542 GPH	N/A

Accessories:

- Aquastat sensor

**LIMITED
LIFETIME** / **1y**
WATER TANK PARTS
WARRANTY

NTI COMPACT SERIES

Mini Tank Electric Water Heater

The **high quality and affordable price** of the NTI Compact mini tank electric water heater makes it the number one choice in over 1 million homes and businesses. **Easy to install**, it plugs into standard wall outlets and the Compact 6 version can be installed horizontally or vertically.

And as always, it comes with the NTI customer support and service that is second to none, as well as a **six-year tank limited warranty**.



Available in three sizes, from **2.7 gal** to **7.0 gal**

Main Features:

- Glass lined steel tank
- Special enamel with titanium content
- 4 bolts stainless steel
- heating element flange
- Magnesium sacrificial anode
- High accuracy and quick response capillary thermostat
- Temperature and pressure valve included



4

BOLTS
FLANGE

Ti

GLASS
LINED TANK

Mg

SACRIFICIAL
ANODE



HIGH ACCURACY
THERMOSTAT



Dimensions

NTI COMPACT 2.5 & 4"

Look at the manual for
NTI Compact 6 dimensions

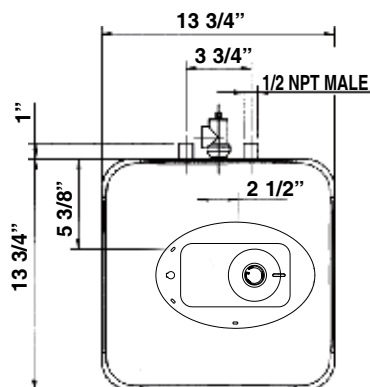

FRONT

NTI COMPACT 2.5

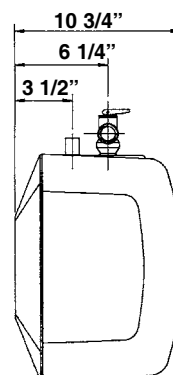

SIDE

NTI COMPACT 4

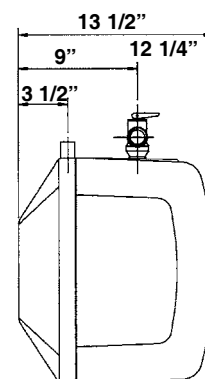

SIDE

Specifications

MODEL	NTI COMPACT 2.5	NTI COMPACT 4	NTI COMPACT 6
Tank capacity	2.7 gal	4.0 gal	7.0 gal *
Dimensions	13 3/4" W x 13 3/4" H x 10 3/4" D	13 3/4" W x 13 3/4" H x 13 1/2" D	17 3/5" W x 17 3/5" H x 14 1/2" D
Weight (empty)	15.5 lbs	17.3 lbs	29.5 lbs
Maximum Water pressure	150 psi	150 psi	150 psi
Recovery rate at 90°F rise	6.8 gal/h	6.8 gal/h	6.8 gal/h
Temperature range	65 – 145 °F	65 – 145 °F	65 – 145 °F
Water connections	1/2" NPT	1/2" NPT	3/4" NPT
Relief valve	Installed	Installed	Included
Nominal Voltage (1 phase)	110/120 Vac	110/120 Vac	110/120 Vac
Nominal current	12 A	12 A	12 A
Power at 120 Vac	1,440 W	1,440 W	1,440 W
Electrical Connection	Plug-in	Plug-in	Hard wired
Sizing			

* 5.1 gal if installed vertically

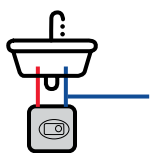

POINT-OF-USE

- Single faucets
- Remote locations
- Single water lines

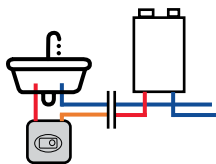

BOOSTER

- No waiting time
- Eliminates cold water sandwich
- No minimum flow rate requirement





Products you need
from people who care



COMBI FURNACES

EMBRACE A NEW
DIMENSION OF COMFORT



GF200 COMBI FURNACE



Modern Convenience of Hot Water and Forced Air Combined

The innovative GF200 is a unique Combi Furnace that offers a new dimension of comfort, **smart efficiency**, and energy savings. Its superior quality, **integrated and compact design**, featuring **two appliances in one**, allows for **fast installation and saves space**.

The GF200 is equipped with Green Furnace control technology features the most advanced components providing whisper quiet heating performance as well as quick and abundant hot water.



One size fits all

97% AFUE/EF

Main Features:

- Eligible for energy efficiency rebates
- Simultaneous operation of space heating and hot water
- 10-stage modulation for smooth temperature control
- Extremely quiet and efficient heat delivery
- Internal recirculation and buffer tank for quick hot water delivery
- Pairs with air conditioning and heat pumps
- Vents in PVC, CPVC or Polypropylene. Check with local jurisdiction



New generation ECM motor and blower for whisper quiet performance.



97% $\frac{\text{AFUE}}{\text{EF}}$

S/S
HEAT EXCHANGER

ECM
MOTOR



2 IN 1

Dimensions

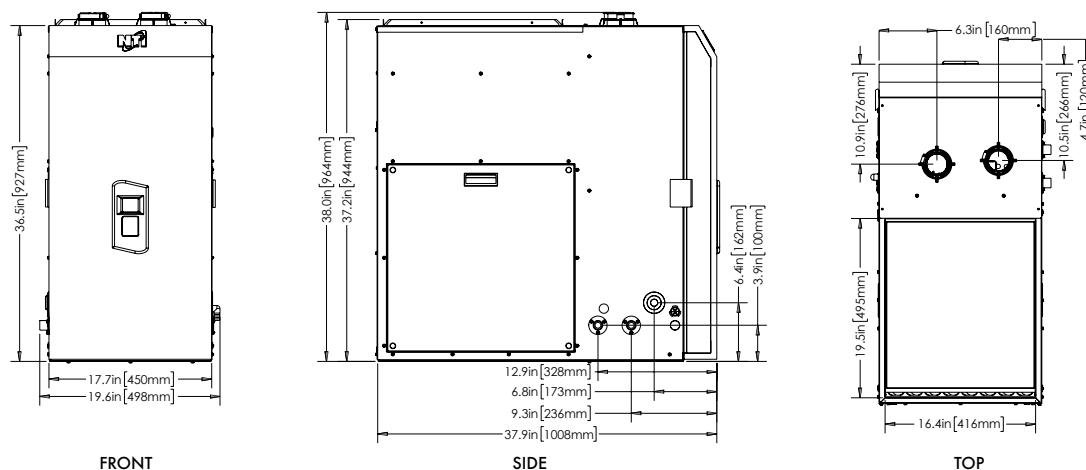

Specifications

		SPACE HEATING	DOMESTIC HOT WATER	
Heat Capacity (Input)	Natural Gas Propane	19,900 - 80,000 BTU/H	19,900 - 199,900 BTU/H	
Energy Efficiency	AFUE	97.1%		
	UEF		0.96	
	EF		0.97	
Hot Water Flow Rate	50 °F (28 °C) Temp Rise		7.8 GPM (29 L/M)	
	65 °F (36 °C) Temp Rise		6.0 GPM (23 L/M)	
	80 °F (44 °C) Temp Rise		4.8 GPM (18 L/M)	
	Minimum		NO MINIMUM REQUIRED	
Dimensions	17¾ in (W) x 38 in (H) x 38 in (D)	Venting Material	Intake	PVC
Weight	248 lbs		Exhaust	PVC/CPVC/Polypropylene*
Installation Type	Indoor	Venting Max Length	3 in	150 ft*
Power Supply	120 V AC, 60 Hz		2 in	60 ft*
		Heat Exchangers	Primary	Stainless Steel
			Secondary	Stainless Steel

* See product manual for details





Products you need
from people who care



OIL AND WOOD BOILERS

WORRY-FREE COMFORT
PROVEN BY THE TEST OF TIME



OIL AND WOOD BOILERS

Caprice

Our most trusted steel oil boiler for over 50 years

- High efficiency operation, AFUE up to 86.9%
- High-capacity copper coil Outdoor reset and warm weather shutdown
- Domestic hot water priority Direct vent option
- Compact size and easy servicing

MODEL	INPUT GPH	GROSS OUTPUT BTU/H	NET OUTPUT BTU/H	AFUE
C85	.68	83,000	72,000	86.80%
C95	.75	91,000	79,000	86.50%
C105	.85	103,000	90,000	86.00%
C125	1	120,000	104,000	85.20%
CAPRICE COMMERCIAL				
C220	1.75	216,000	188,000	86.90%
C230	1.85	226,000	197,000	86.30%
C250	2	241,000	210,000	85.50%

MODEL	C85-125	C220-340
Stack Size (")	5	8
Water Volume (US Gal)	15	26
Shipping Weight (lbs)	362	440
Overall Length (")	20	23
Overall Width (")	20	23
Overall Height (")	36	42
Inlet-Outlet Size (Npt)	1 1/4	1 1/4
Relief Valve Size (Npt)	3/4	3/4
Drain Size (Npt)	1/2	1/2
Direct Venting	C95-125	—
Side Wall Venting (SSV-1)	C95-125	C220-305
Heating Surface (sq ft)	18	26
Standard Coil Size	S4	S4
Max. Coil Size	1-S5	1-S5
CRN Approved*	1279.7	1278.7

*Must request at time of order.



WF Series

NTI WF Series is the most efficient, compact wood boiler on the market.

- Compact sizes eliminate the need for floor reinforcement
- Greater heating surface
- Lower stack temperature
- No boiler tubes
- Less possibility of creosol buildup
- Thermostat heat control
- Wet leg, high-efficiency boiler design
- Designed to A.S.M.E. requirements

DIM	1 1/4" NPT
	16"W
	25 1/2" D
SUPPLY	1 1/2"
RET	1 1/2"
RV	3/4"
DRAIN	1/2"
SQ. FT. SURFACE	20
WEIGHT	625 lbs.
WATER CAP	43 Imp Gal.
BTU CAPACITY	95,000



| NOTES

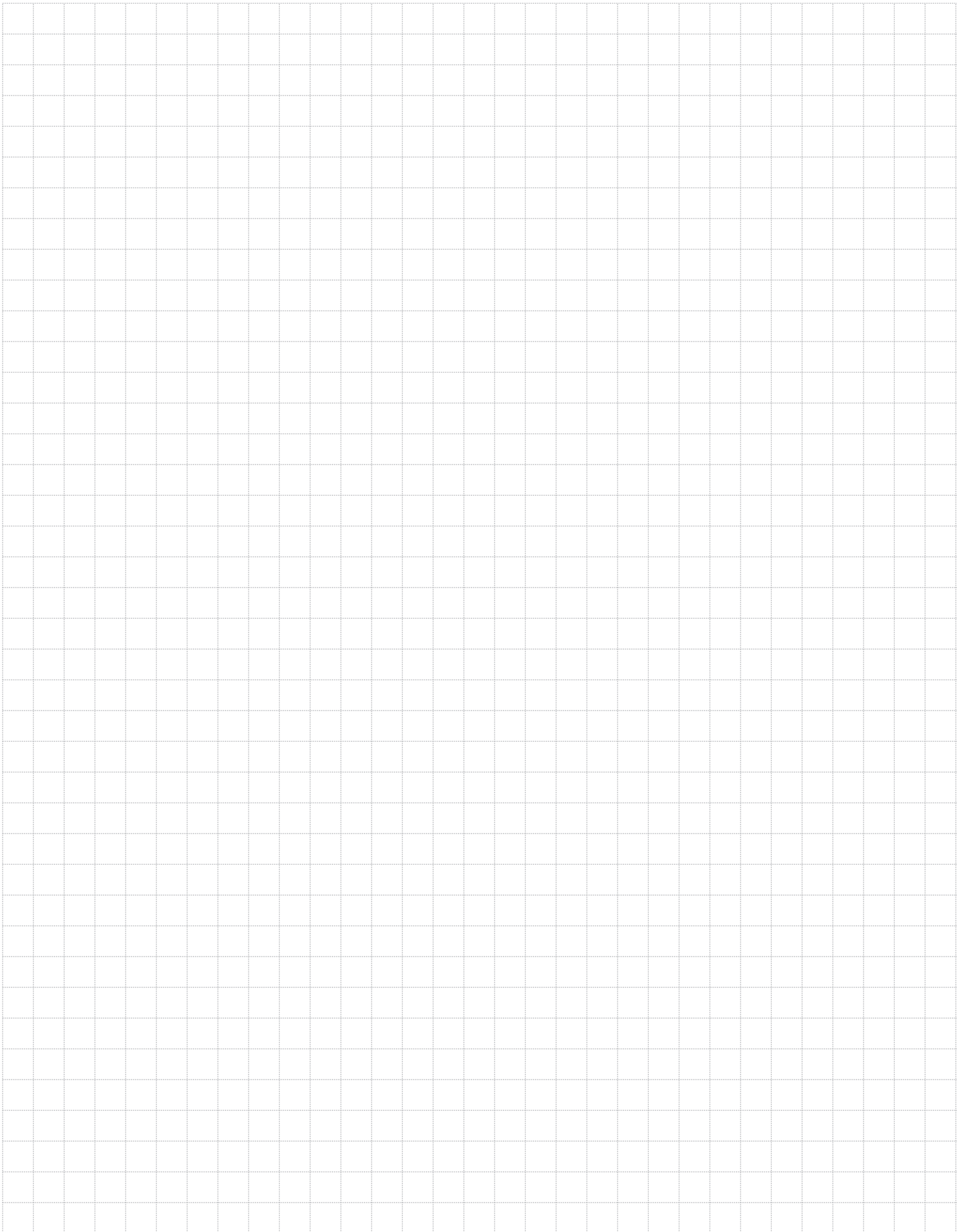

Join the pros! Participate in a training session today!

Contact us at:

training@ntiboilers.com

to get in touch with our training team and
learn about available dates in your area.



Interested in our products? Contact our Sales Managers:

Canada

VP of Sales Canada

Andrew Smith
asmith@ntiboilers.com

Atlantic Canada

Stacy Baskin
sbaskin@ntiboilers.com

Eastern Canada

Gloria Coelho
gcoelho@ntiboilers.com

Western Canada (BC)

Rob Johnston
rjohnston@ntiboilers.com

Western Canada (Alberta)

Travis Loewen
tloewen@ntiboilers.com

USA

VP of Sales USA

David Walsh
dwalsh@ntiboilers.com

North East

Ted Lowe
tlowe@ntiboilers.com

Mid Atlantic

Steve Wieland
skwieland@ntiboilers.com

Lakes East

David Miller
dmiller@ntiboilers.com

Lakes West

Cory VanVickle
cvanvickle@ntiboilers.com

US West

Shane Frandsen
sfrandsen@ntiboilers.com



Products you need
from people who care

30 Stonegate Drive,
Saint John, NB
E2H 0A4

ntiboilers.com
info@ntiboilers.com

Toll: 1-800-688-2575
Direct: 506-657-6000