

Project Name: _____ Date: _____
 Location: _____
 Engineer: _____
 Contractor: _____ Rep: _____

1 – GENERAL SPECIFICATIONS

Product Features:

- ✓ Certified to ANSI Z21.13 / CSA 4.9 Gas-fired Boiler Standard
- ✓ ASME "H" stamped boiler, designed and constructed in compliance with the ASME Boiler and Pressure Vessel Code Section IV
- ✓ SA-268 S43940 Stainless Steel Heat Exchanger
- ✓ Maximum operating pressure 50 psi [344.7 kPa]
- ✓ Modulating burner, 8:1 turndown ratio
- ✓ Direct Spark Ignition
- ✓ Wall (standard) or floor mounting (w/ opt. kit, NTI part # 84630)
- ✓ Zero clearance to combustibles
- ✓ 57-199 MBH [57,000-199,000 BTU]
- ✓ Field conversion from Natural Gas (factory) to Propane
- ✓ Optional Sidewall vent kits
- ✓ 120VAC outlet for condensate pump
- ✓ On/Off switch

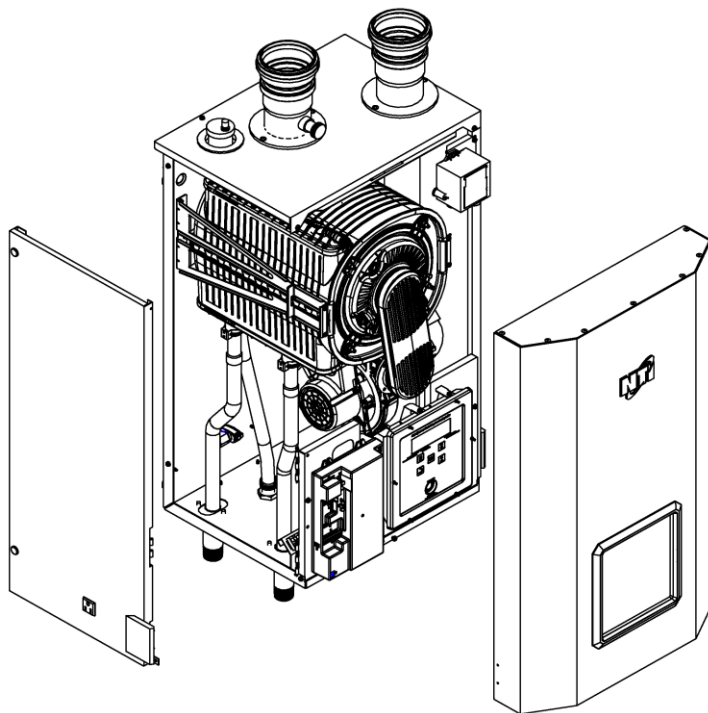

Factory Supplied Items

- ✓ 10K thermistor outdoor sensor
- ✓ 30PSI [206.8 kPa] ASME Relief Valve
- ✓ 60PSI [413.7 kPa] Pressure Gauge
- ✓ Condensate Trap
- ✓ Water Pressure Sensor

Control Features

- ✓ Integral microprocessor safety control
- ✓ Domestic Hot Water Priority timer
- ✓ Outdoor Reset
- ✓ Warm weather shut down
- ✓ Freeze protection
- ✓ Cascade up to 16 Tx series boilers
- ✓ 3 circulator outputs
- ✓ Outdoor reset temperature boost
- ✓ Compatible with indirect water heater w/ tank sensor or switch
- ✓ Service reminder
- ✓ Adjustable pump post purge
- ✓ Run time accumulation
- ✓ Night setback option
- ✓ Lockout and error history

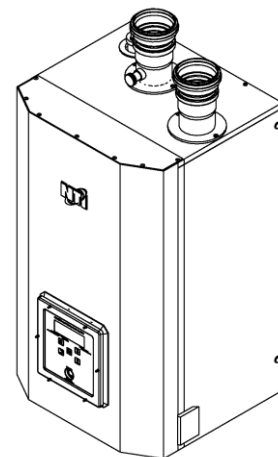

Model Specifications

| Model | Water Conn. NPT, in. | Gas Connection NPT, in. | Vent/Air-Intake Pipe Diameter in. | Vent/ Air-Inlet Max. Length, Ft. | | Approx. Wt. w/Water lb. |
|-------|----------------------|-------------------------|-----------------------------------|----------------------------------|---------------|-------------------------|
| | | | | 2 in. Venting | 3 in. Venting | |
| Tx51 | 1 (Male) | ½ (Female) | 2 or 3 | 100 | 150 | 77 |
| Tx81 | 1 (Male) | ½ (Female) | 2 or 3 | 100 | 150 | 79 |
| Tx101 | 1 (Male) | ½ (Female) | 2 or 3 | 100 | 150 | 86 |
| Tx151 | 1 (Male) | ½ (Female) | 2 or 3 | 100 | 150 | 87 |
| Tx200 | 1 (Male) | ½ (Female) | 3 | NA | 100 | 109 |

Heating Specifications

| Model | Input | | Heating Capacity BTU/hr | AFUE % | NET I=B=R Rating BTU/hr |
|-------|------------|------------|-------------------------|--------|-------------------------|
| | Min BTU/hr | Max BTU/hr | | | |
| Tx51 | 7,125 | 57,000 | 52,000 | 94 | 45,000 |
| Tx81 | 10,250 | 82,000 | 75,000 | 94 | 65,000 |
| Tx101 | 12,625 | 101,000 | 92,000 | 94 | 80,000 |
| Tx151 | 18,875 | 151,000 | 139,000 | 94 | 120,000 |
| Tx200 | 24,875 | 199,000 | 184,000 | 94 | 160,000 |

Performance Specifications

Tx51-200 Performance Chart

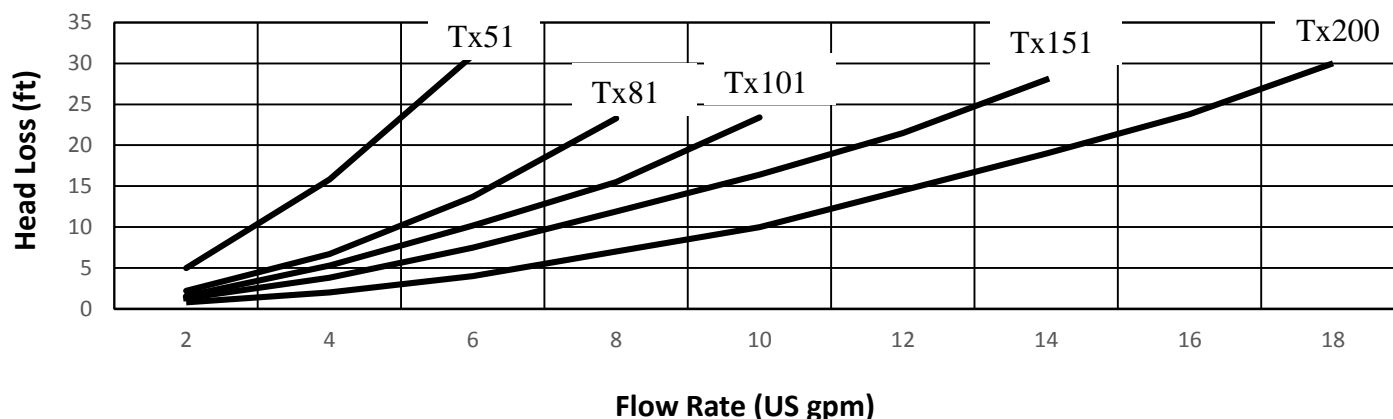

2 – PRODUCT DIMENSIONS [IN.]

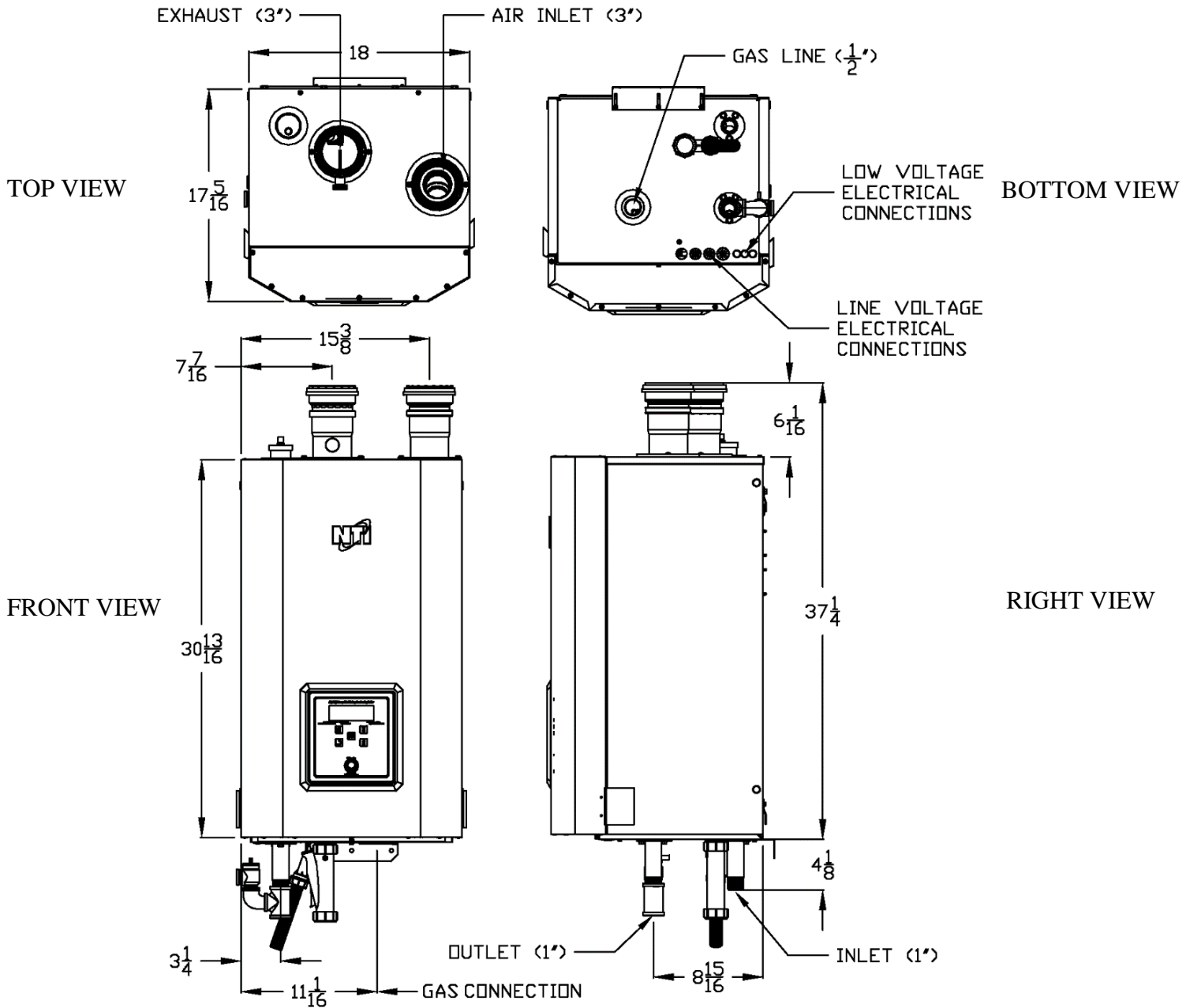

RECOMMENDED CLEARANCES [IN.]

| Front | Top | Sides | Back | Bottom | Flue Pipe |
|-------|-----|-------|------|--------|-----------|
| 36 | 24 | 12 | 0 | 24 | 1 |

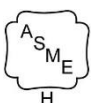

3 -- FIELD WIRING

